

Modular glazing System in Multi-Wall Polycarbonate
WALL- NORTHLIGHT with 20 mm panels

Rev. 11

p. 3

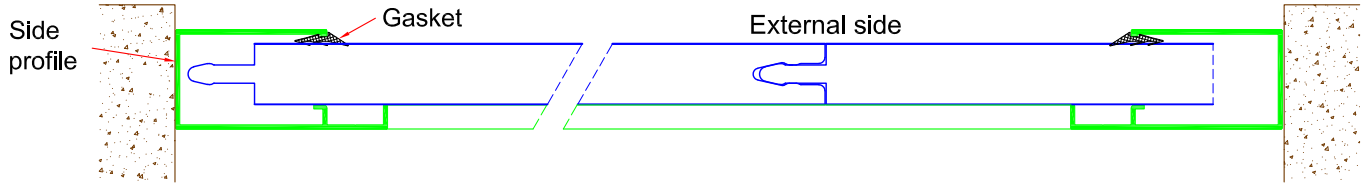
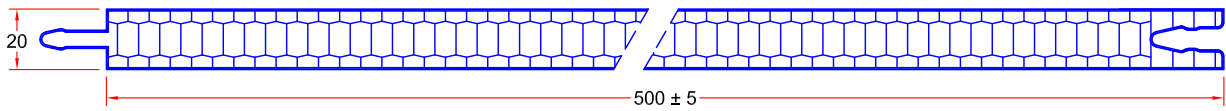

HORIZONTAL SECTION with framing profiles in anodised aluminium

Wall application

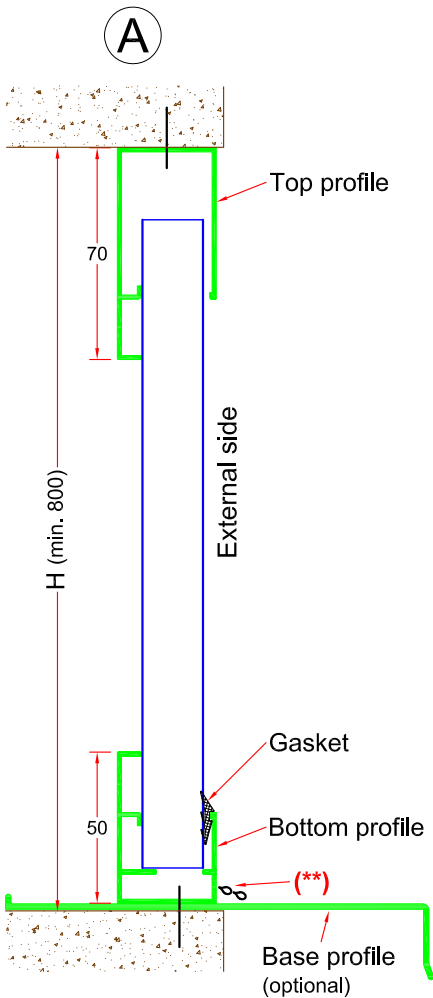

External applications

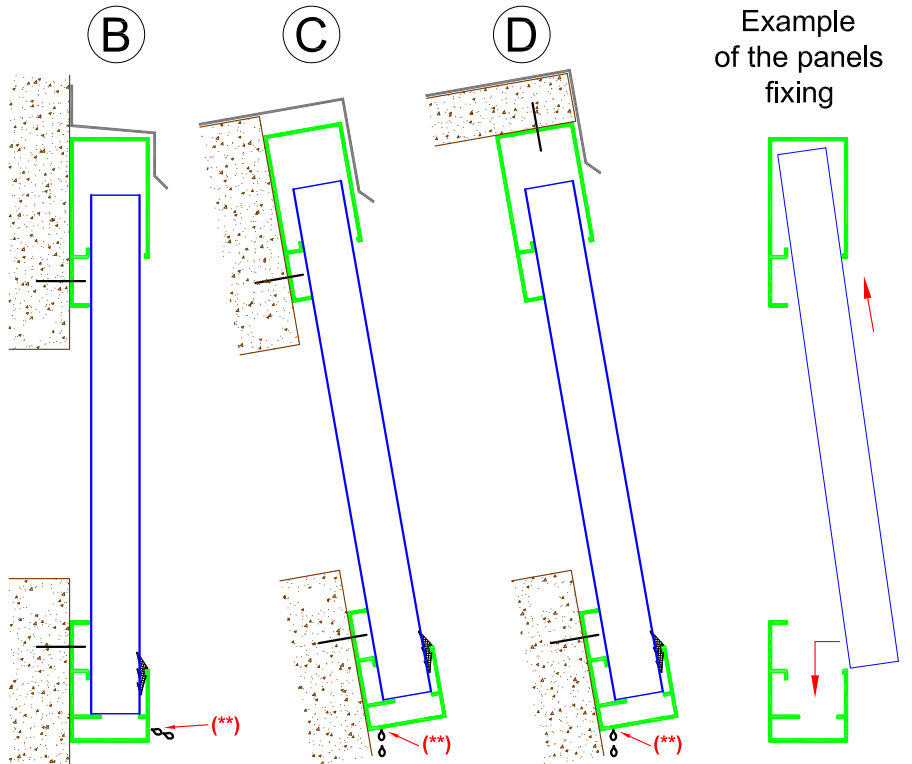

(**) Drill holes for drainage

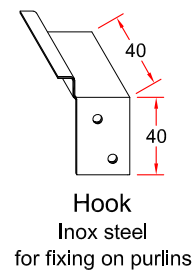
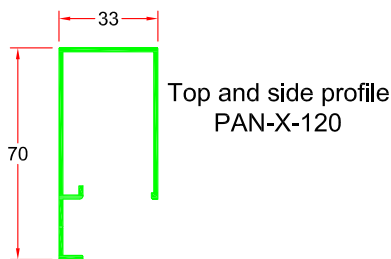
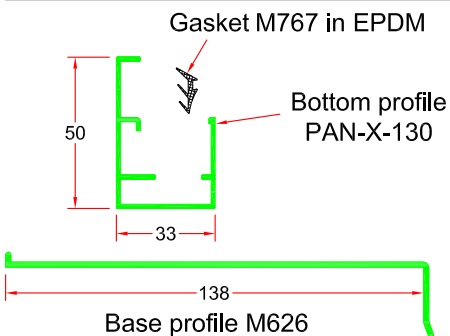

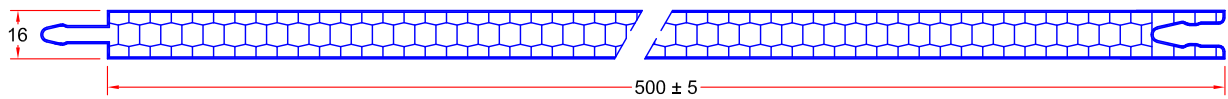

HORIZONTAL SECTION with framing profiles in anodised aluminium

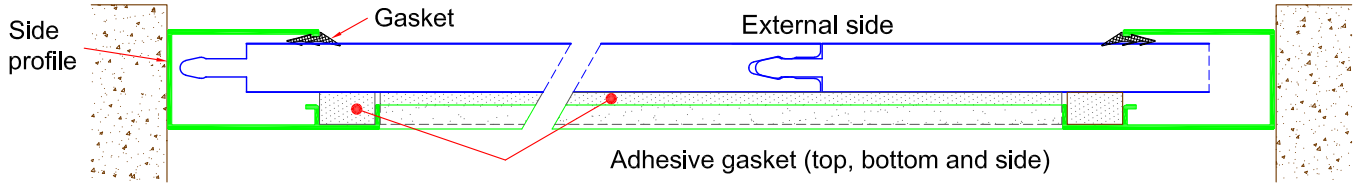

HORIZONTAL SECTION with framing profiles in anodised aluminium

Wall application

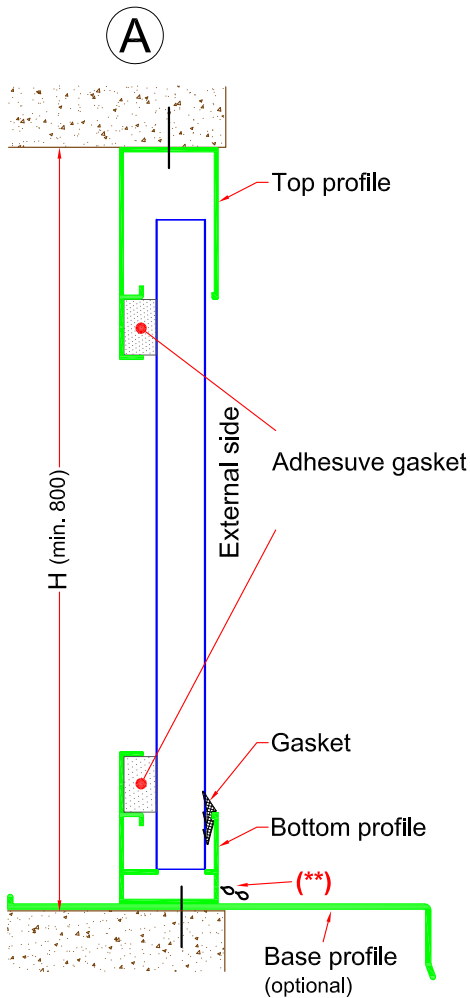

External applications

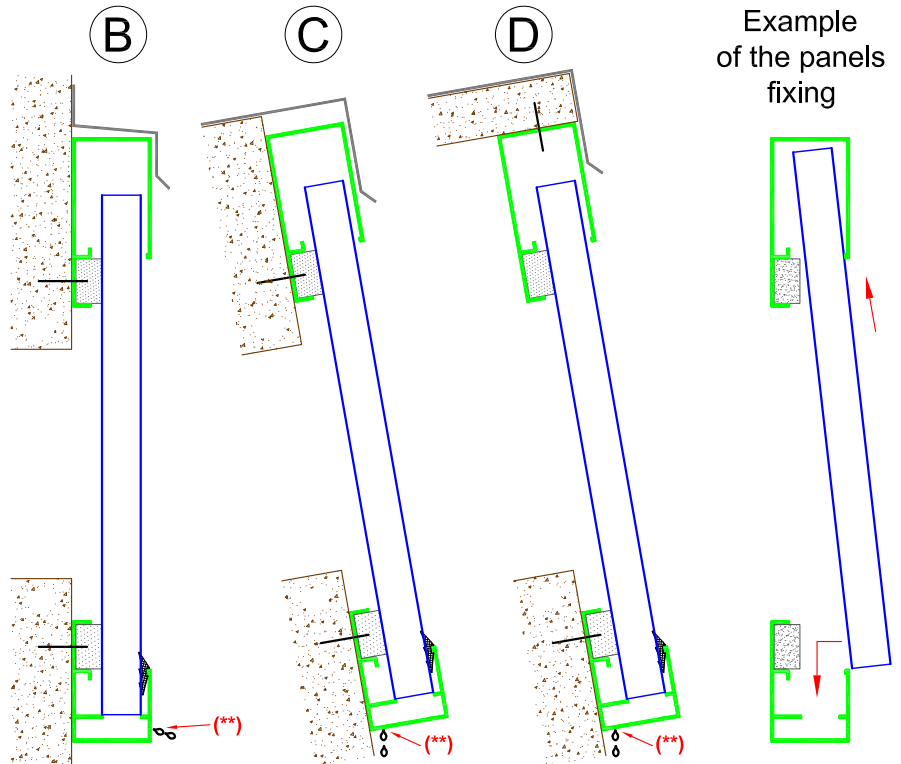

(**) Drill holes for drainage

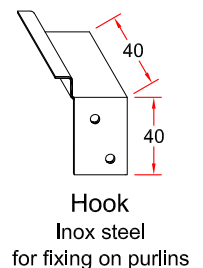
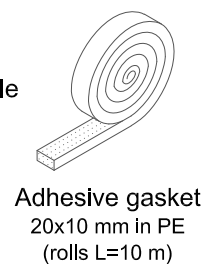
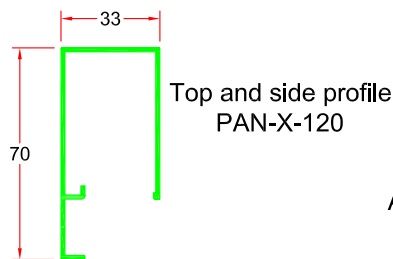
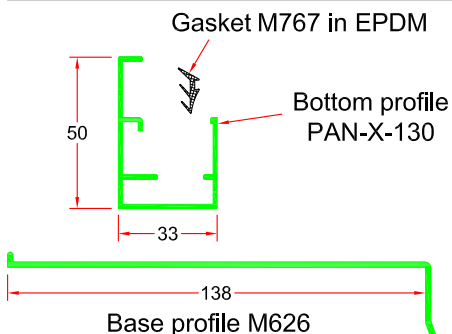

PANELS for EXTERNAL USE

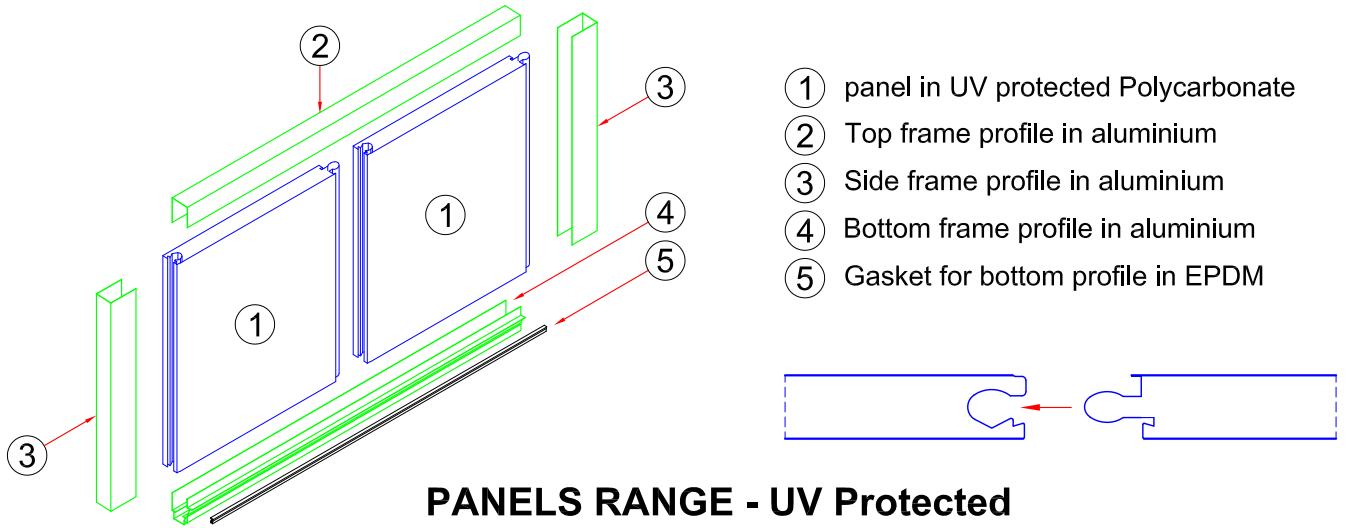

PANELS RANGE - UV Protected

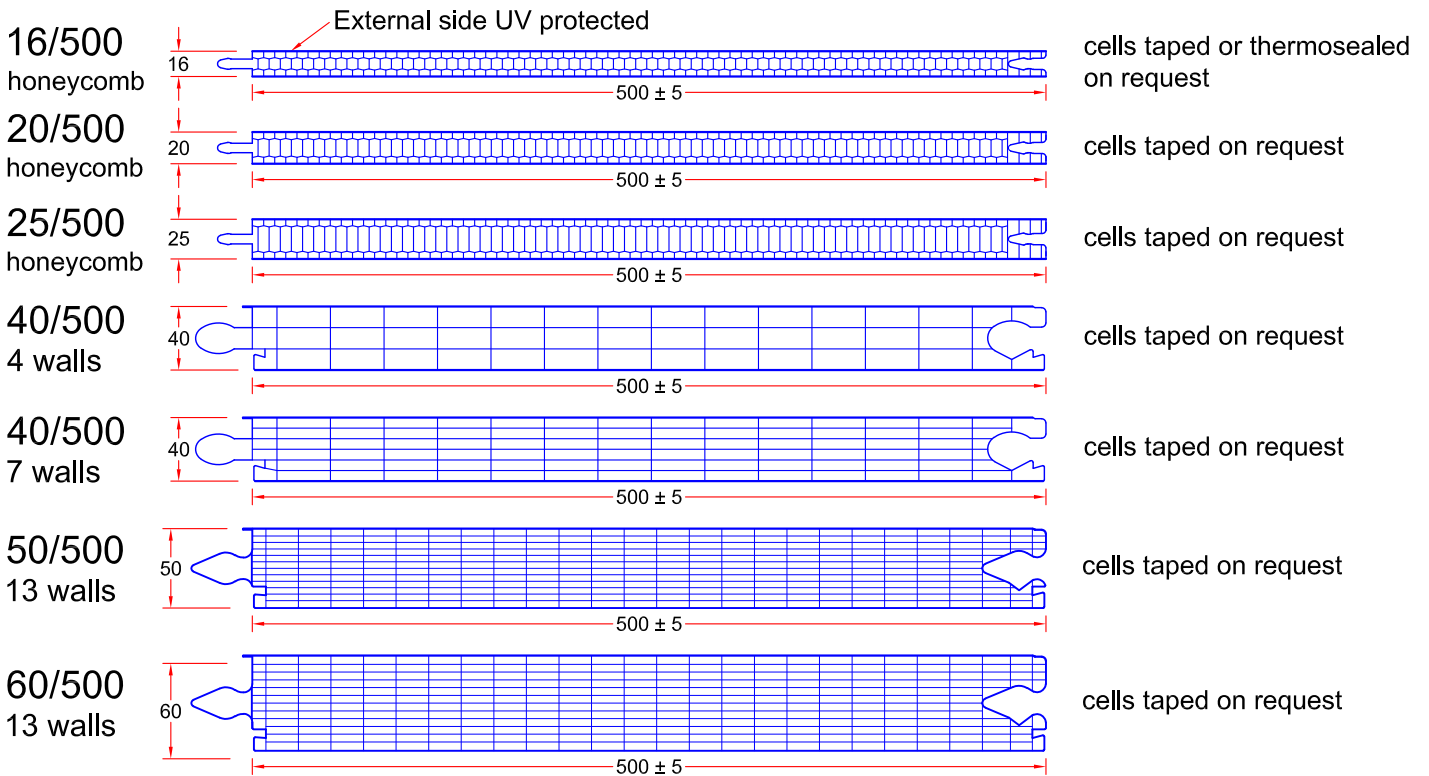

TECHNICAL DATA		16/500	20/500	25/500	40/500/4	40/500/7	50/500	60/500		
Panel modular width		500 ± 5							mm	
Pannel thickness (± 0,5 mm)		16	20	25	40	40	50	60	mm	
No. of walls		[4]	[4]	[4]	4	7	13	13		
Thermal transmission [U-value]		1,99	1,81	1,60	1,41	1,08	0,79	0,71	W/m ² K	
Light transmission		Clear satinized (*)	~ 69	~ 67	~ 64	~ 53	~ 56	~ 40	~ 39	%
		Opaline (*)	~ 52	~ 43	~ 35	~ 33	~ 36	~ 22	~ 16	%
SPANS q = 500 N/m ² (wind ≈ 100 km/h) q = 800 N/m ² (wind ≈ 130 km/h)		D max	D max	D max	D max	D max				
		1.300	1.400	1.600	2.300	2.350	3.400	4.100	mm	
		1.200	1.300	1.450	2.050	2.100	3.000	3.500	mm	
Fire classification EN13501-1		B s1 d0								
Thermal expansion		0,065							mm/m K	
Temperature range		-40 / +120							°C	
(*) standard colours - other colours produced on request										

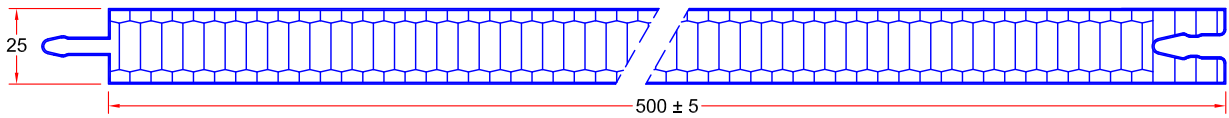

HORIZONTAL SECTION with framing profiles in anodised aluminium

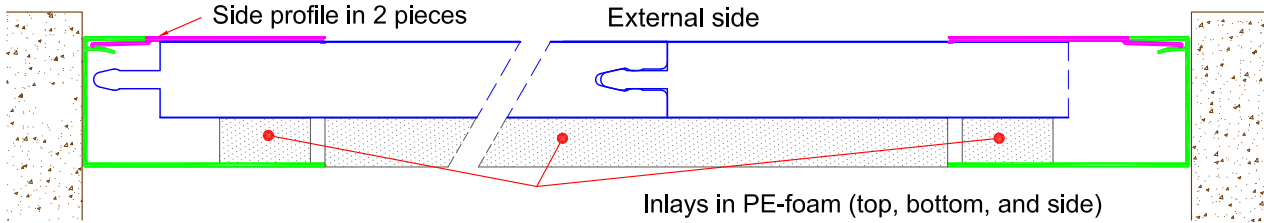

VERTICAL SECTIONS with framing profiles in anodised aluminium

Wall application

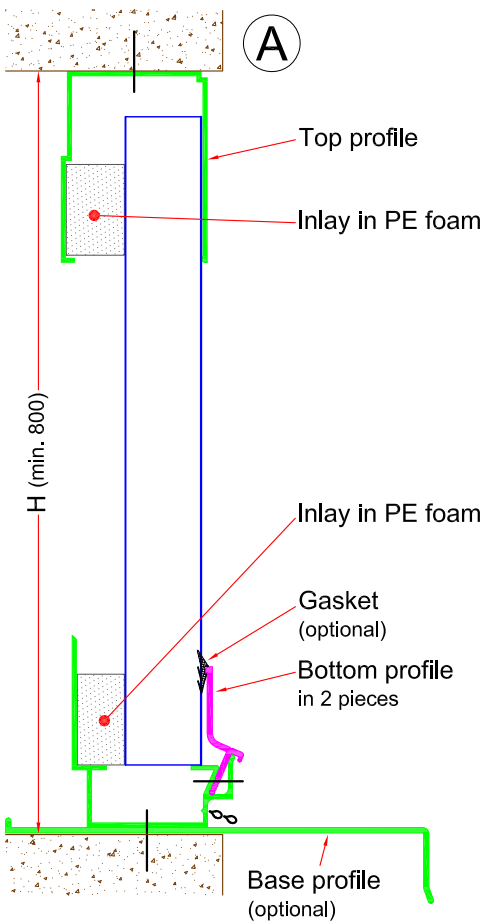

External applications

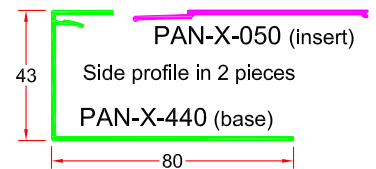
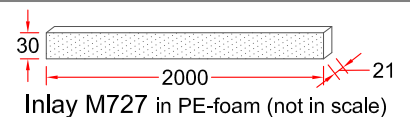
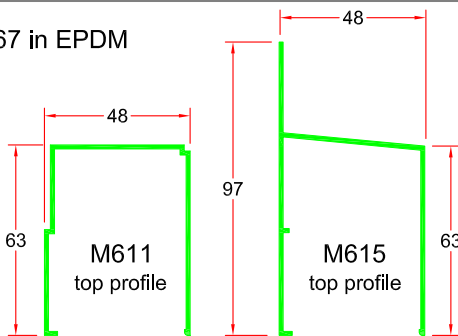
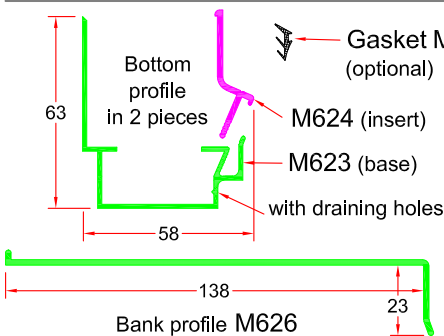
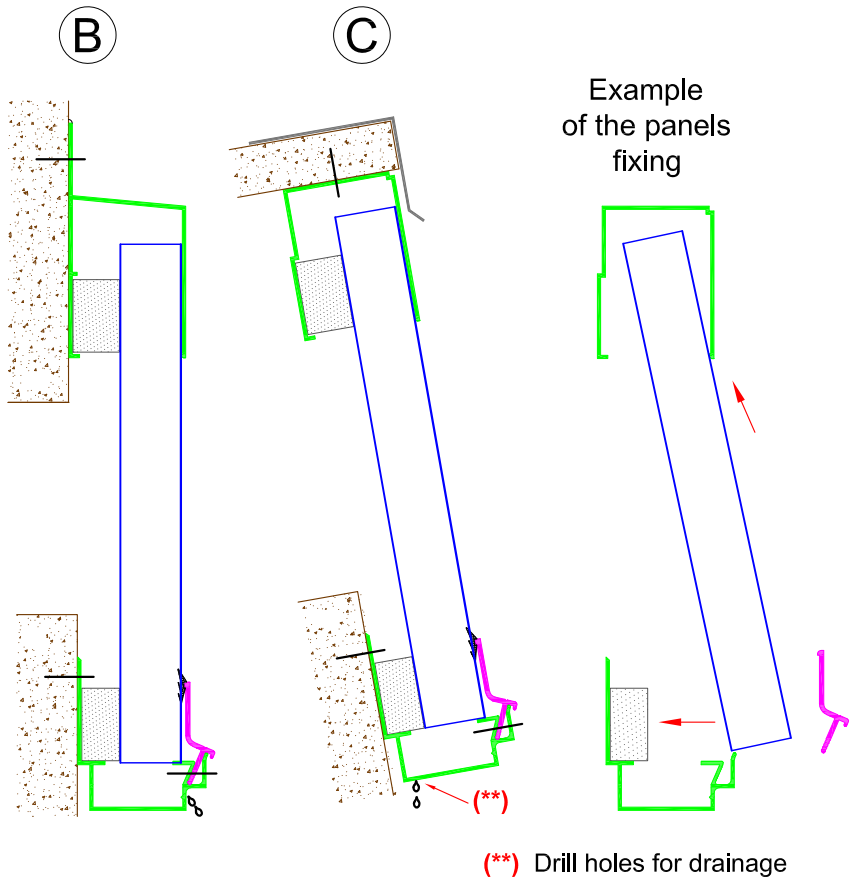

Modular glazing System in Multi-Wall Polycarbonate WALL- NORTHLIGHT with 40 mm panels

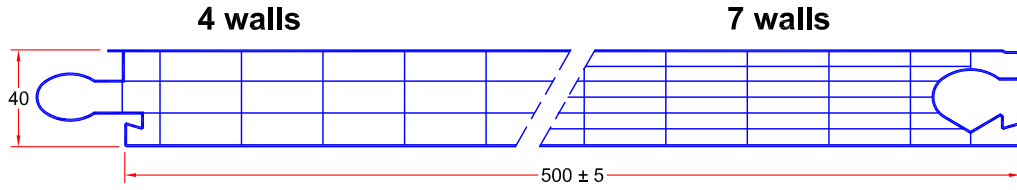

HORIZONTAL SECTION with framing profiles in anodised aluminium

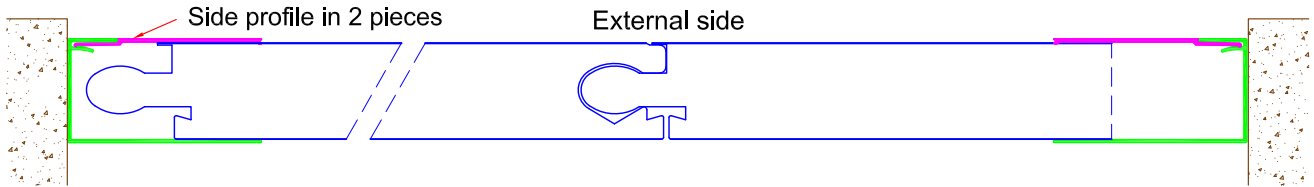

VERTICAL SECTIONS with framing profiles in anodised aluminium

Wall application

External applications

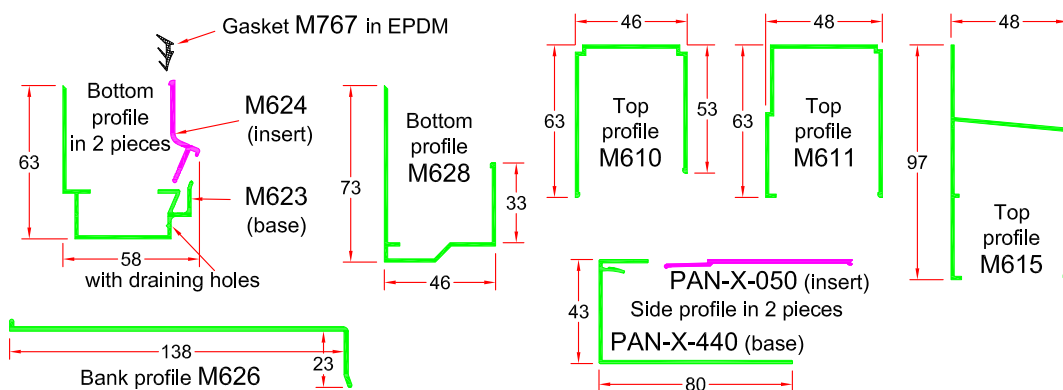
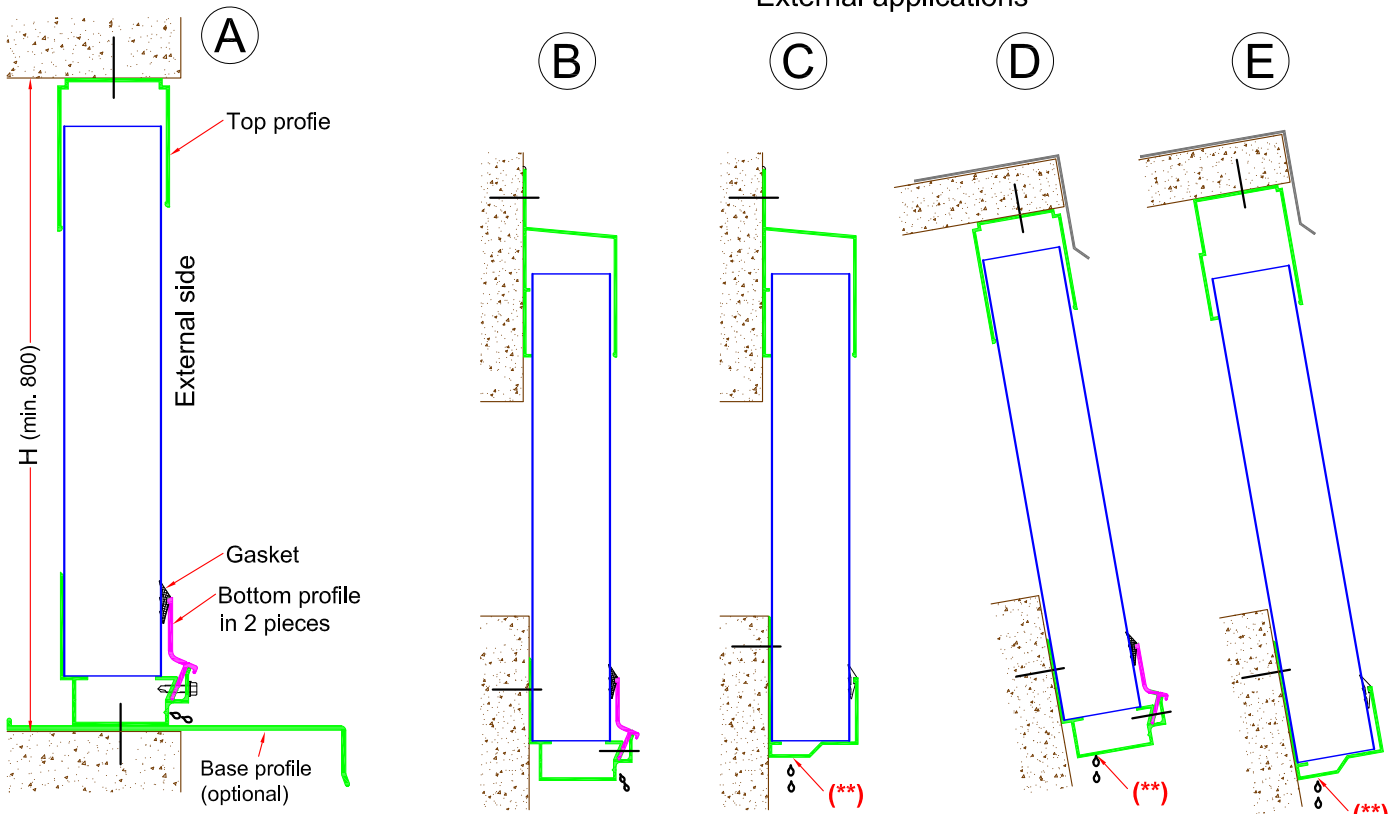

Hooks for intermediate purlins

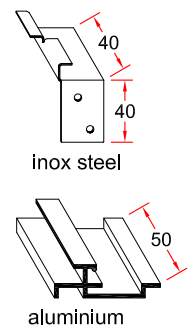

WINDOW FRAMES

Supplied assembled - size BW x HW on request - opening manual or motorized

HORIZONTAL SECTION (type opening outside) - profiles without thermal break

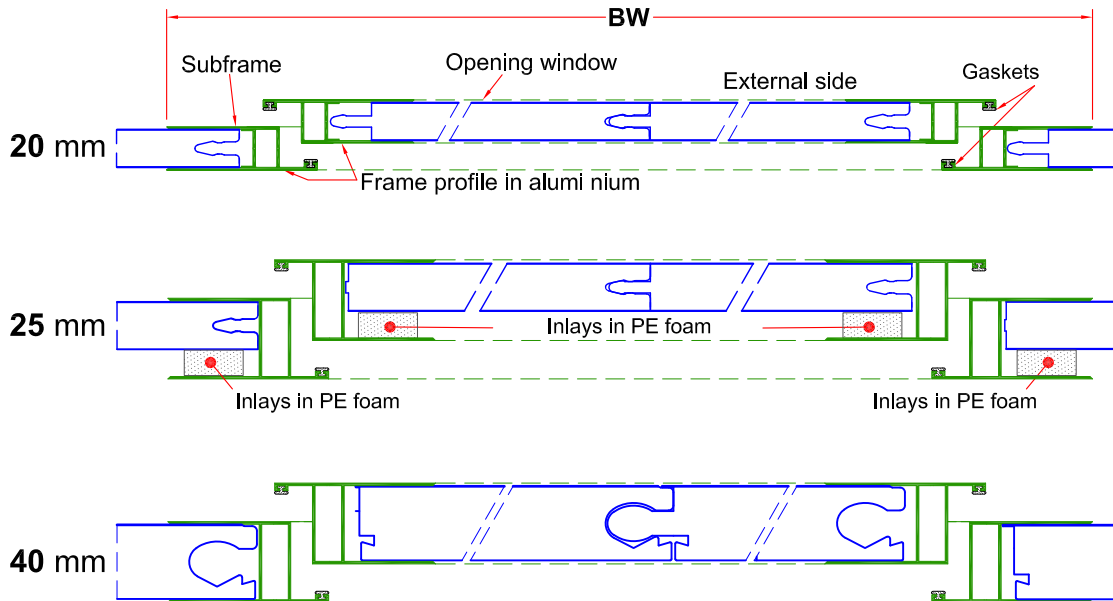

VERTICAL SECTIONS - profiles without thermal break

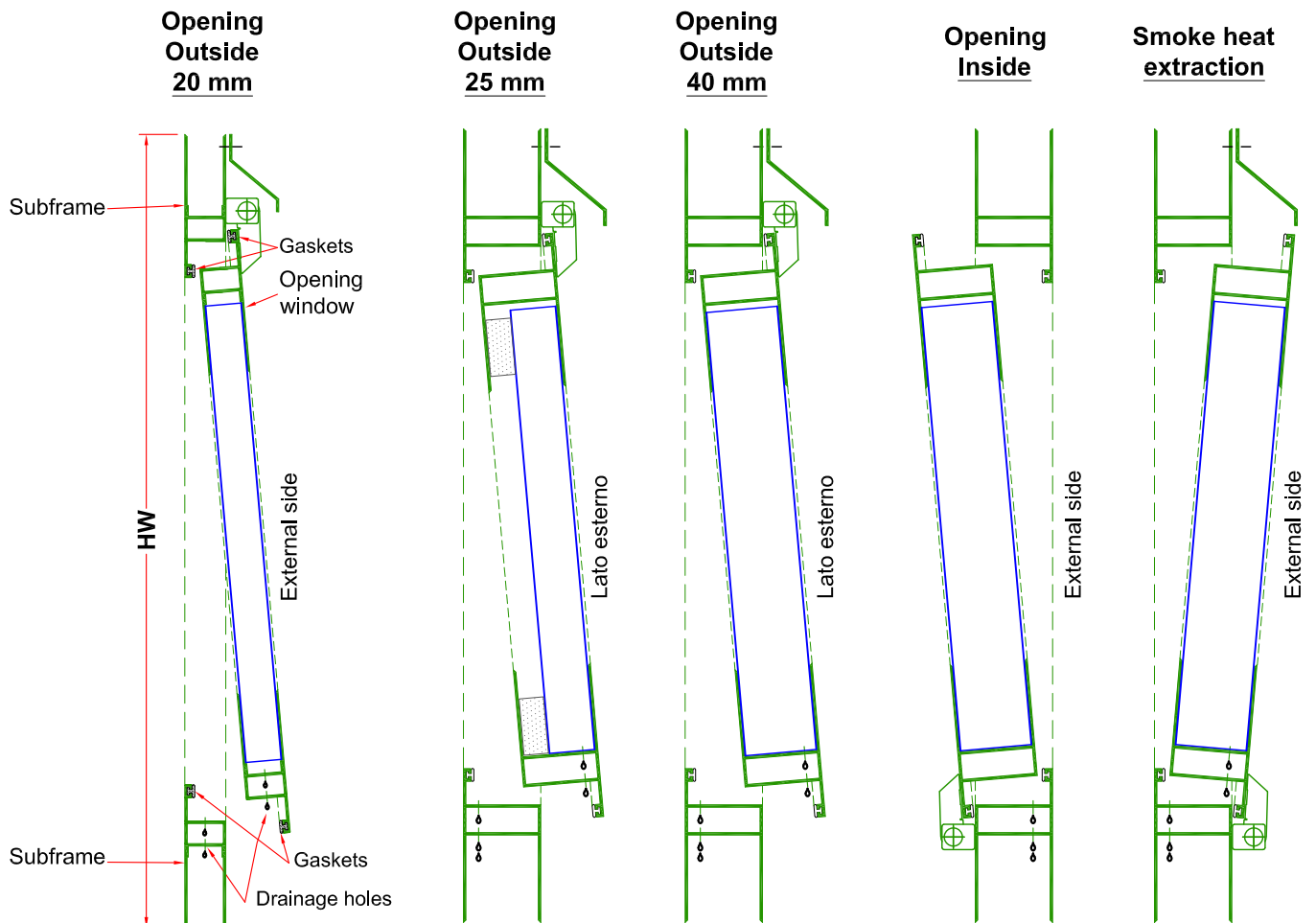

SECTIONS with 40 - 50 - 60 mm panels

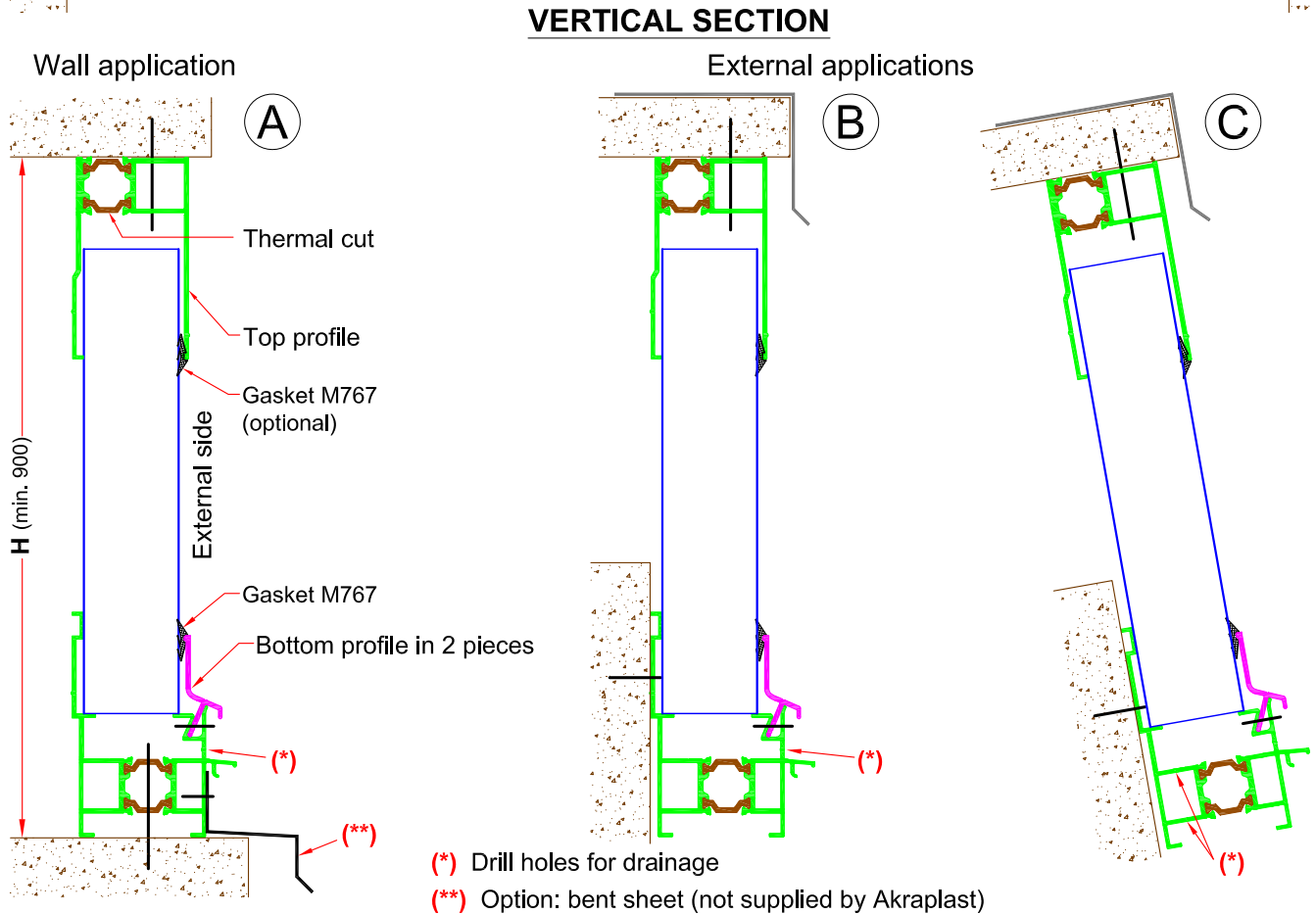
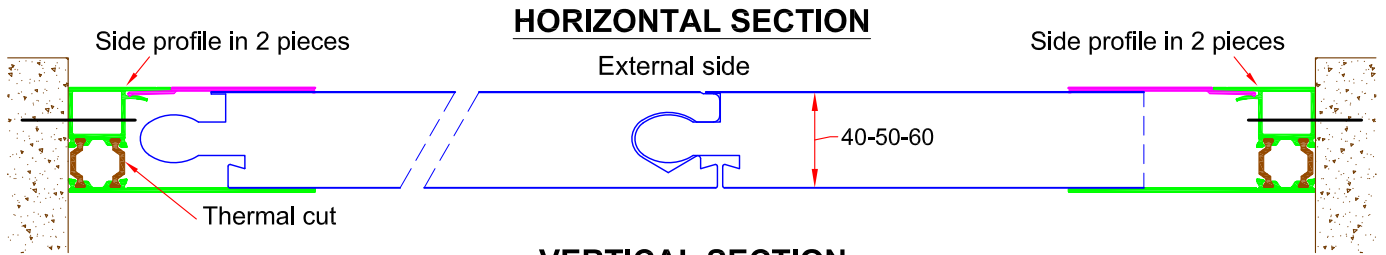

Top profile

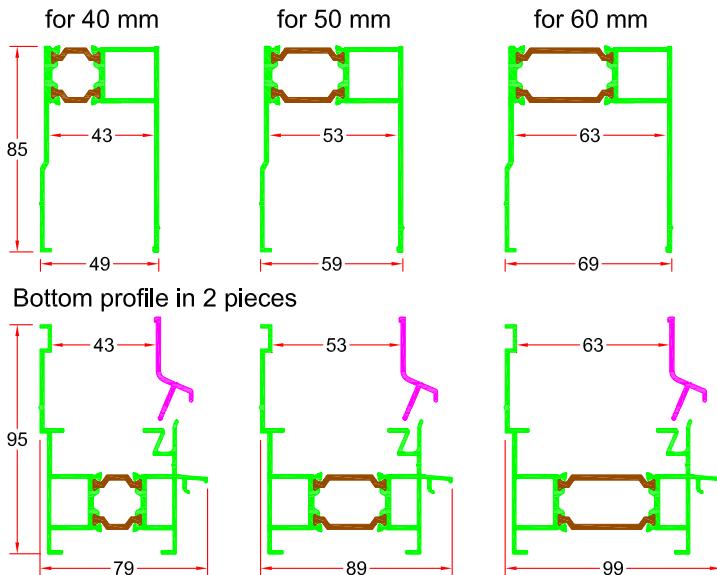

Side profile in 2 pieces

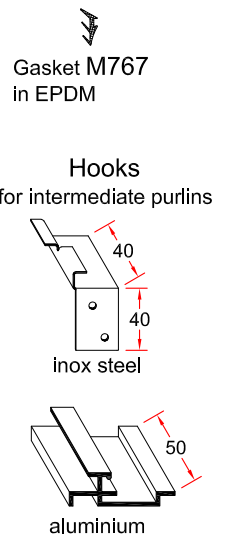
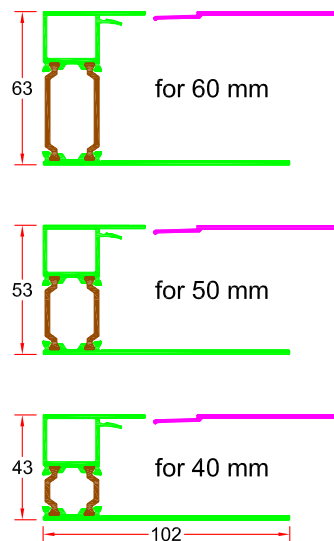

SECTIONS with 40 - 50 - 60 mm panels

HORIZONTAL SECTION

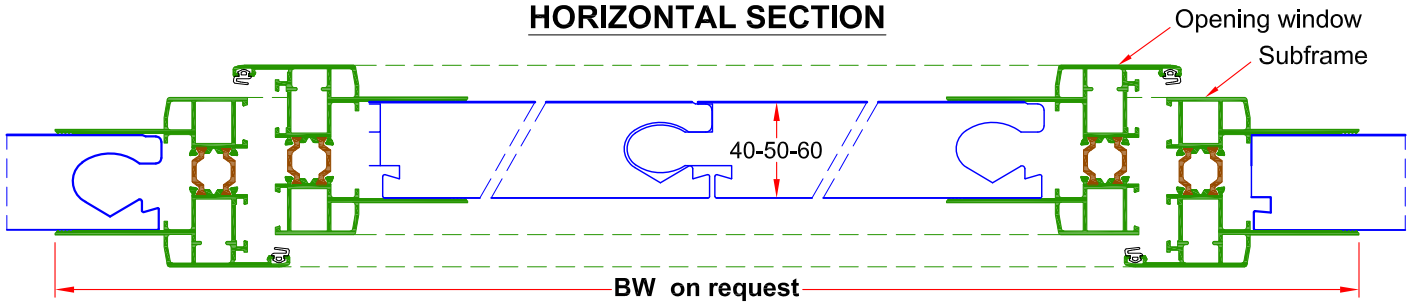

Application with top and bottom profiles

VERTICAL SECTION

type opening outside (*)

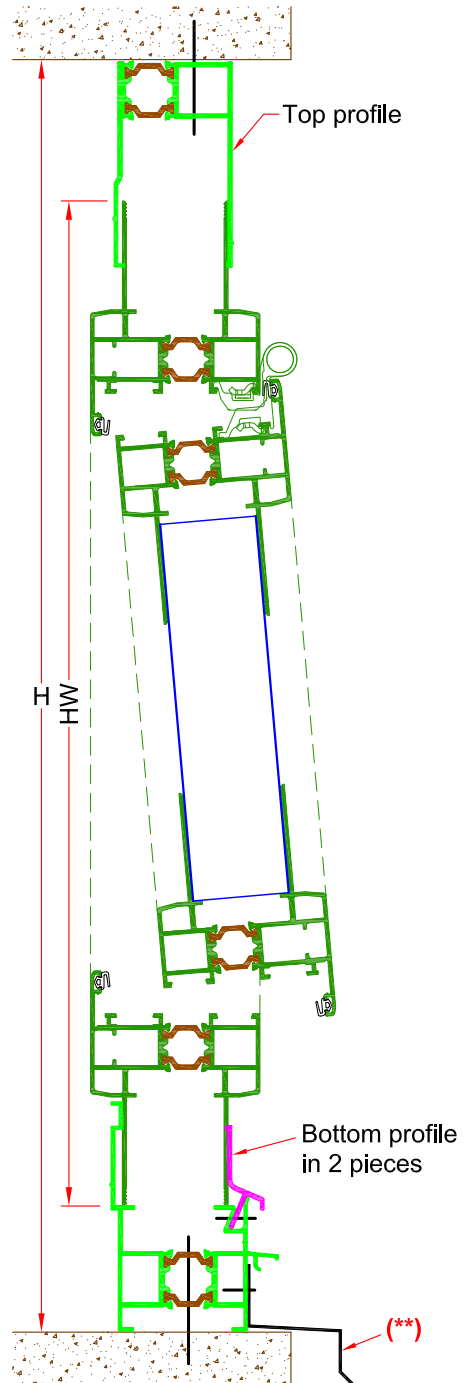
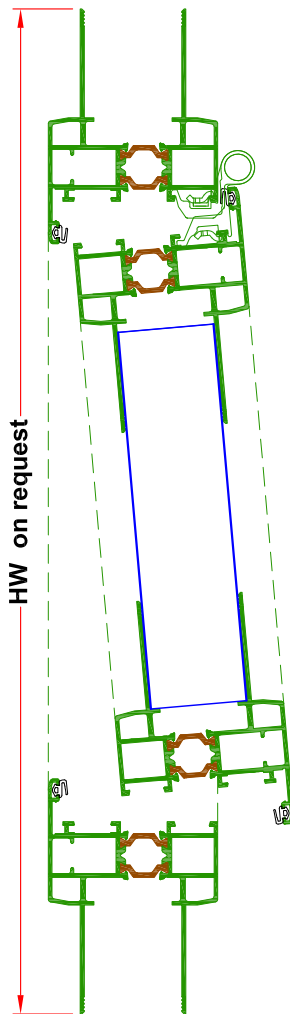

(*) Also available opening inside and smoke heat extraction type

(**) Option: bent sheet (not supplied by Akraplast)

