

Modular glazing System in Multi-Wall Polycarbonate
WALL- NORTHLIGHT with 20 mm panels

Rev. 11

p. 3

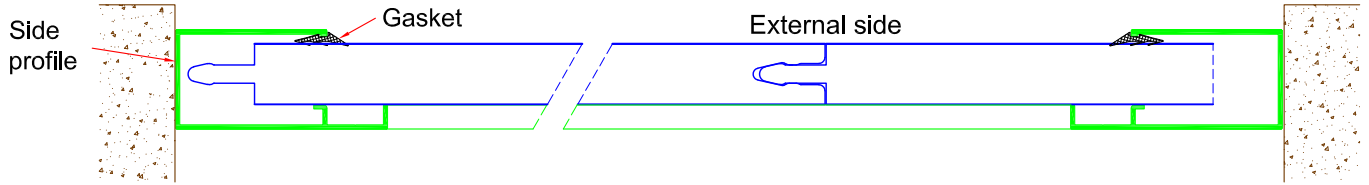
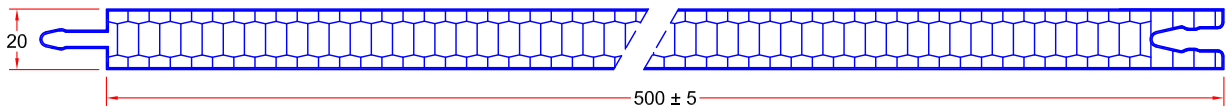

HORIZONTAL SECTION with framing profiles in anodised aluminium

Wall application

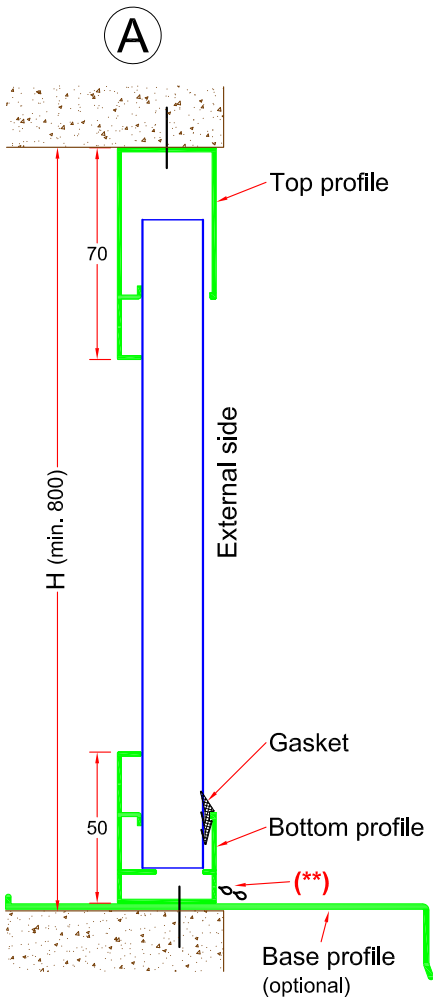

External applications

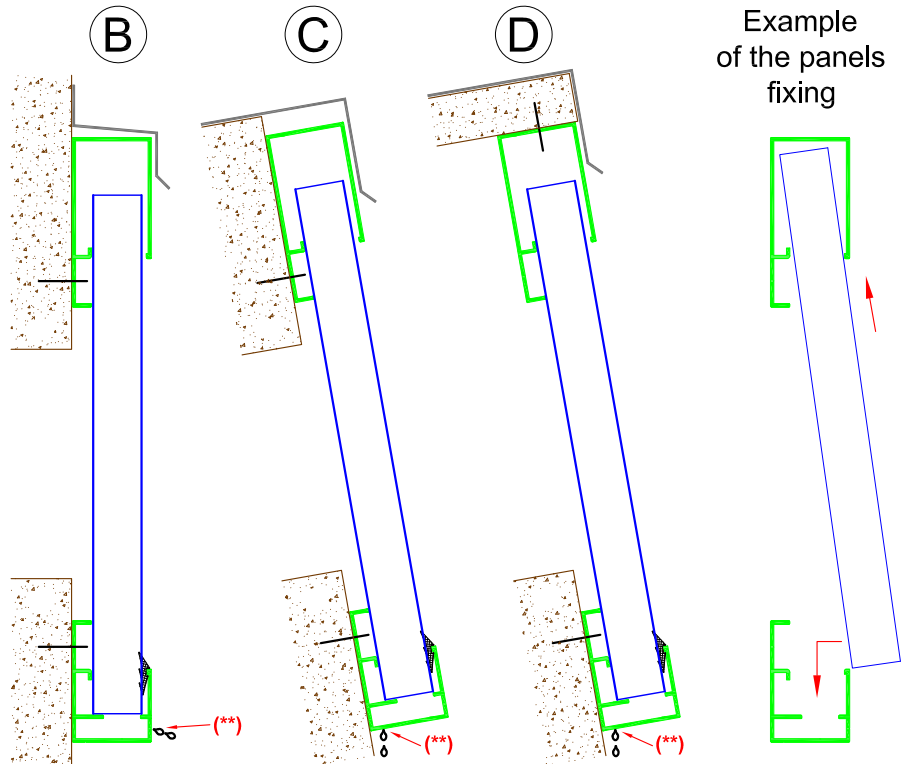

(**) Drill holes for drainage

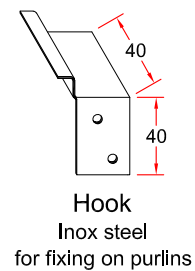
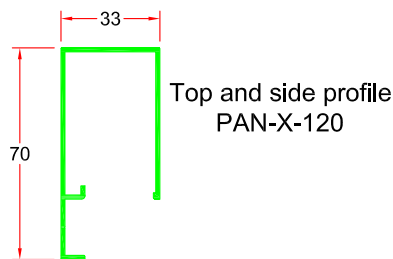
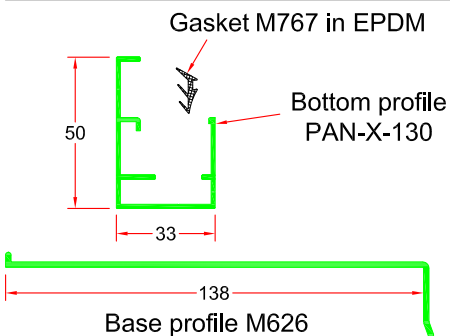

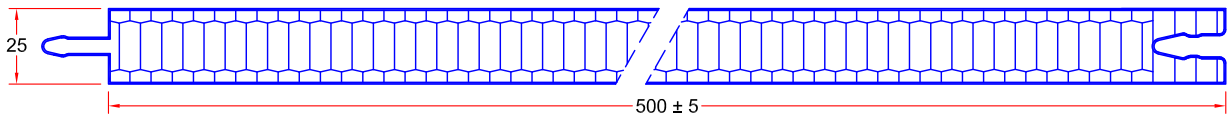

HORIZONTAL SECTION with framing profiles in anodised aluminium

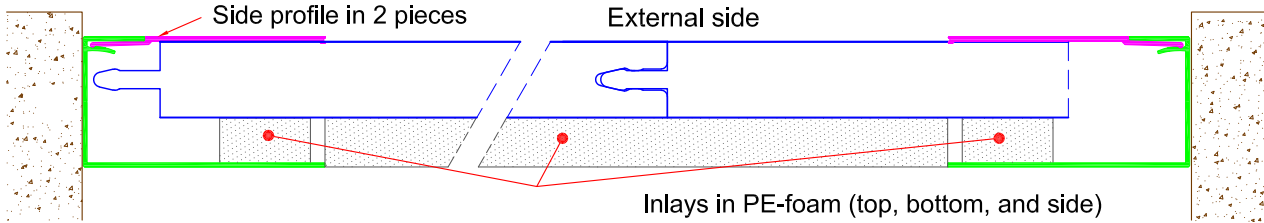

VERTICAL SECTIONS with framing profiles in anodised aluminium

Wall application

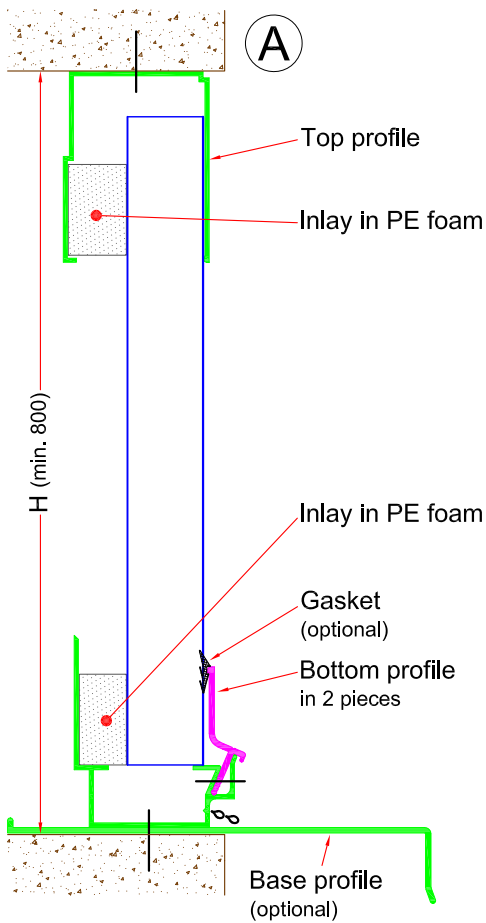

External applications

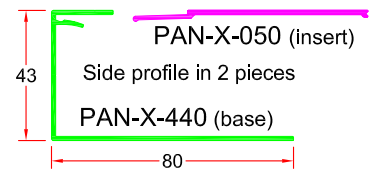
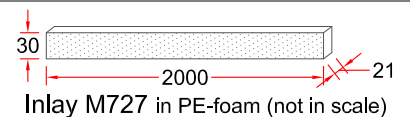
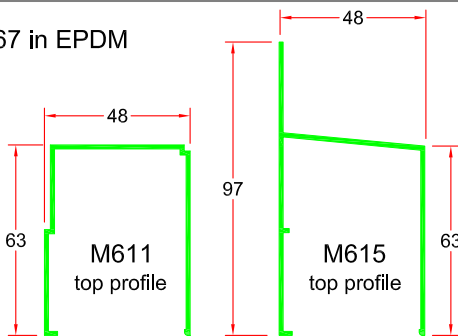
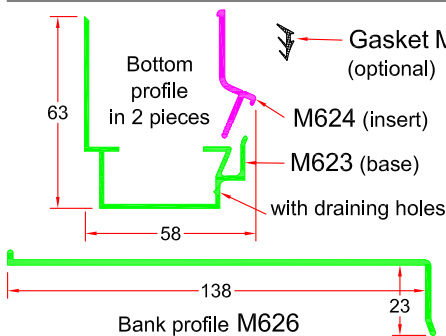
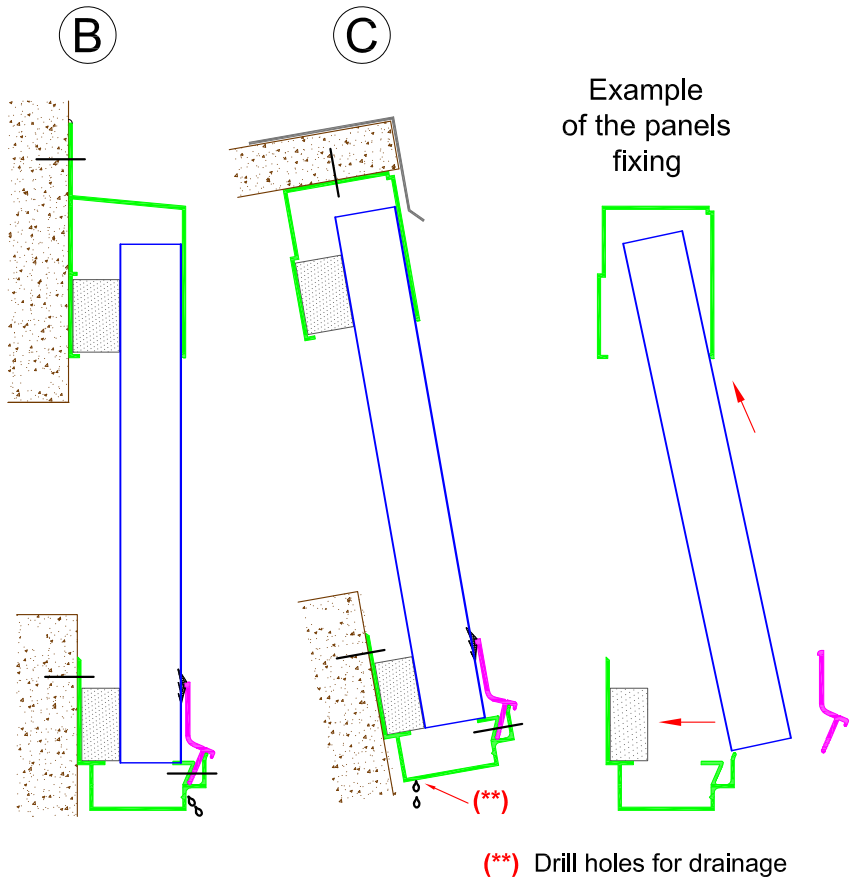

Modular glazing System in Multi-Wall Polycarbonate WALL- NORTHLIGHT with 40 mm panels

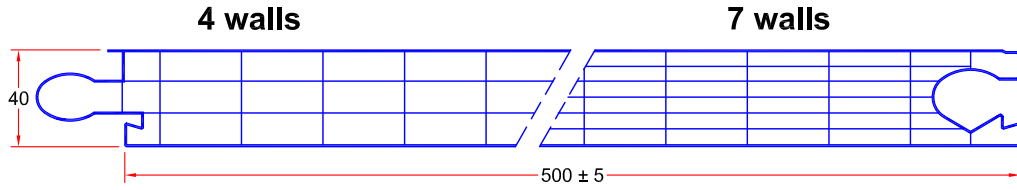

HORIZONTAL SECTION with framing profiles in anodised aluminium

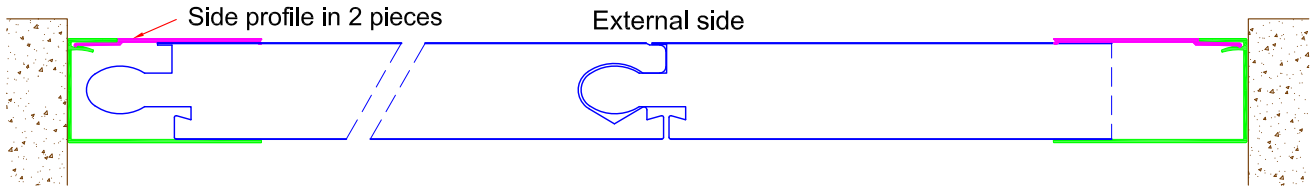

VERTICAL SECTIONS with framing profiles in anodised aluminium

Wall application

External applications

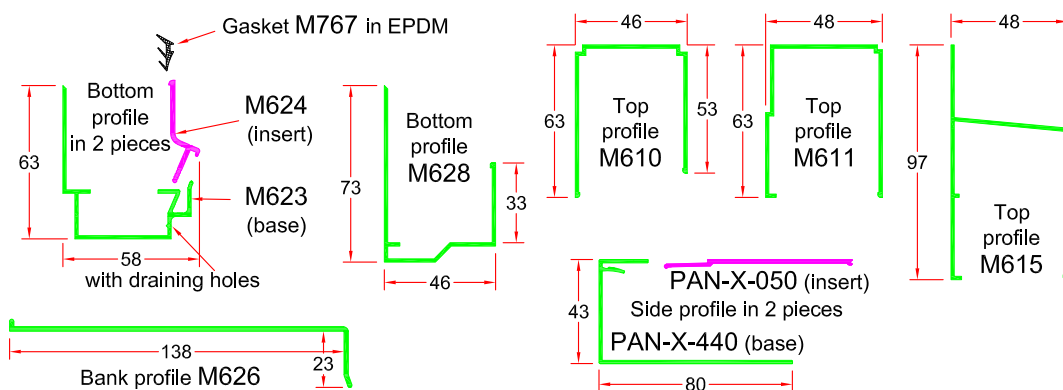
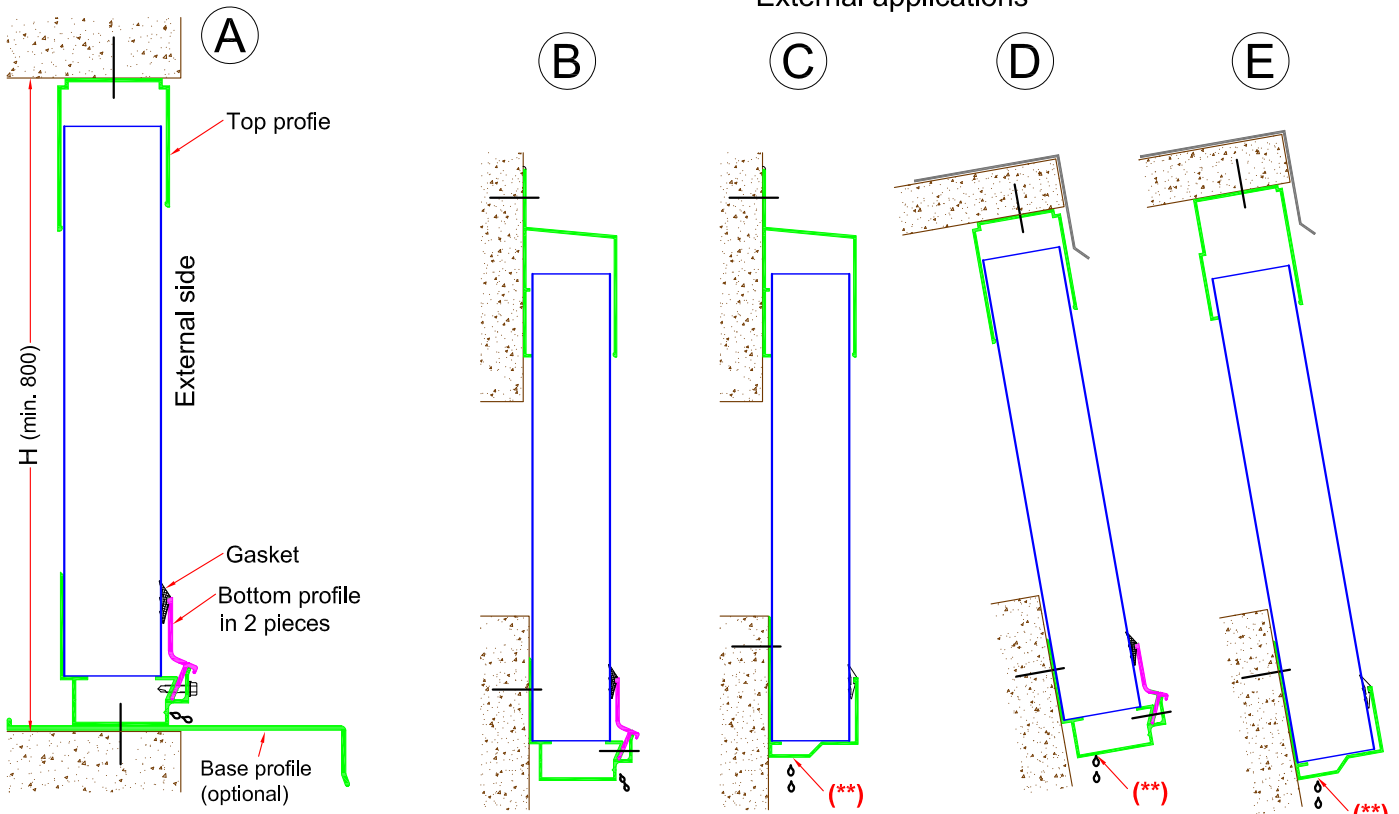

Hooks
for intermediate purlins

