



Prefabricated Building

PVC windows





The company we have the pleasure to present in this brochure is an important and dynamic industrial firm based in Italy. Since the 1980s it has offered customers modern, flexible production machines, creative design from the very start of each project, and the exceptional quality of its products which are also given the CE mark in conformity with the highest technical standards of our times.

Entrepreneurship, commitment and dedication, and close relations between the Piva family and management on a business and personal level have made Piva Group S.p.A. what it is today: a solid company that produces aluminium and PVC frames for the sector of modular pre-fabricated goods (modular housing units, insulated units, pre-fabricated boxes, etc.), for mobile homes and bungalows, and for residential buildings. The Mondial Infissi™ division also produces sandwich insulation panels for the industrial construction sector (industrial buildings, industrial soundproofing) while the Pannelli System™ division caters to many other sectors in the world of industrial plant engineering.

The production premises in Italy are situated in an industrial district of 100,000 square metres in Roncanova di Gazzo Veronese, in the province of Verona; it is the “heart of the company”, where all the input is channelled and where the headquarters is located. Other production sites covering a total of 30,000 square metres are located in Salamanca, central Spain, where aluminium and PVC frames have been produced since 2004.

Piva Group S.p.A. has branches in and exports its products all over Europe and around the world. Its total aggregate turnover is about 100 million Euros. The Group expects to expand even further with the research and development of new products also for new emerging markets.

The mission of the Piva Group is to acquire all the very best certification for all its products.



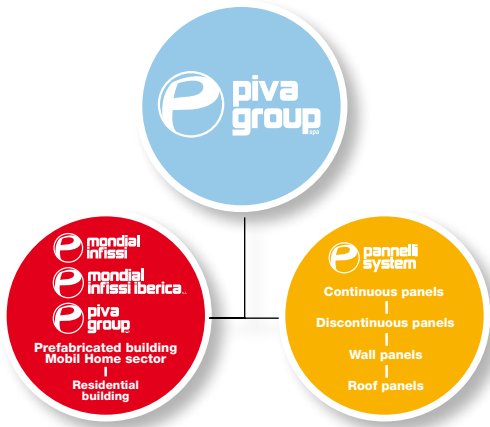

Why use PVC?

To use PVC profiles for frames is to preserve our forests. PVC consists of 57% salt and 43% petroleum. This material is, therefore, mainly natural in origin and uses only a limited amount of non-renewable raw material.

To use PVC profiles for frames is to reduce pollution. The production of PVC requires less energy than other materials such as aluminium.

PIVA GROUP's frames also guarantee a high degree of heat insulation, permitting further energy savings in terms of indoor heating and thereby reducing air pollution.

To use PVC profiles for frames is to promote clean production. Compared to the conversion of other materials, like wood and aluminium, the processing of PVC produces very little powder residue and low emissions of carbon dioxide and sulphur dioxide. The plastic materials for the frames are among the very strongest: they are suitable for use even after a century.

to protect against rain

PVC does not absorb water and the corners are heat-welded to make the window completely seamless.

The particular shape of the profile makes the rain flow off easily outwards. The profile has cavities for dispersing any seepage, and it remains fully impermeable even in the most extreme weather conditions.

to protect against fire

PVC contains 57% chlorine, and this fact alone makes it a fire-resistant polymer. The presence of chlorine, a highly fire-resistant substance, improves the reaction of PVC to fire, slowing down the spread of flames and effectively putting them out.





Casement windows

PIVA 58 - external fitting casement windows	p. 06
PIVA 58 - external fitting casement windows with roller shutter	08
PIVA 58 - internal fitting casement windows	10
PIVA 58 - internal fitting casement windows with roller shutter	12
PIVA 75 - external fitting casement windows	14
PIVA 75 - external fitting casement windows with roller shutter	16
PIVA 75 - internal fitting casement windows	18
PIVA 75 - internal fitting casement windows with roller shutter	20

Awning windows

PIVA 58 - awning windows	p. 22
PIVA 58 - awning windows with roller shutter	24

Sliding windows

PIVA SLIDING - sliding windows	p. 26
PIVA SLIDING - sliding windows with roller shutter	28
PIVA SLIDING - Germany windows	30
PIVA SLIDING - double-glazed Germany windows	32
PIVA SLIDING - double-glazed Germany windows with roller shutter	34

Vertical sliding windows

PIVA Vertical sliding - vertical sliding windows with roller shutter	p. 36
--	-------

PIVA58

tilt&turn windows
external fitting

The PIVA58 tilt&turn window was designed for applications on outside and inside walls (mainly thin ones) of new, old, provisional or temporary structures.

This type of window is strong and practical, and the particular way it opens makes it suitable for every field of application.

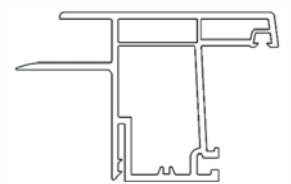
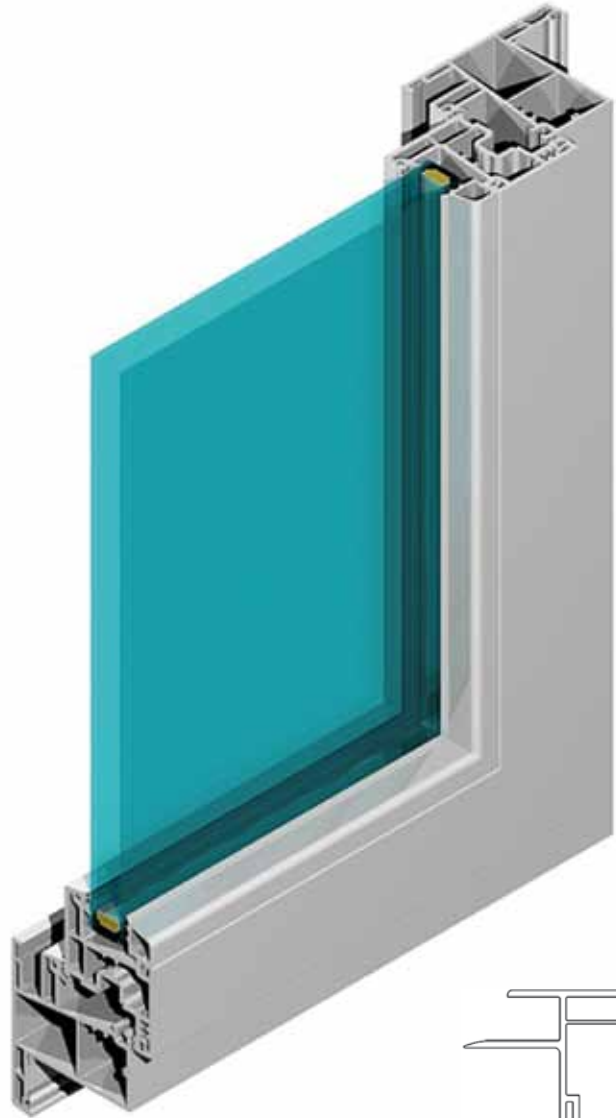

• Panel frame.



• Possibility for external shutters.

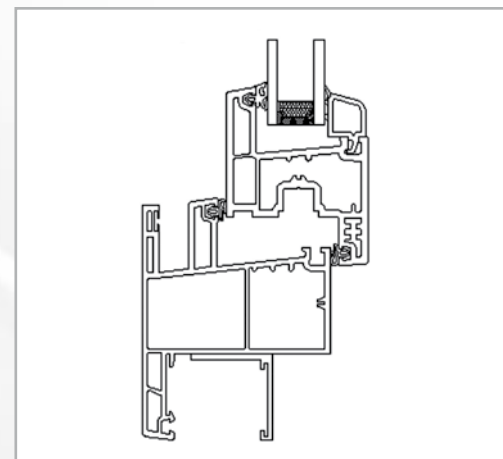

• Single-leaf tilt&turn window without roller shutter.

casement windows

Tilt&turn window - PIVA58

external fitting



Technical Information

- Extruded profiles in white rigid PVC
- Seal system with co-extruded EPDM joints on the panel and frame
- Depth of frame system: 77 mm
- Depth of panel: 58 mm
- Choice of glass between 23 and 30 mm thick (single or double glazing)
- Opening system with modular fittings made of galvanized steel and with pressure die cast aluminium components
- Closing system with white nylon handle
- Optional surface coating applied by top certified specialized firms
- Optional application of aluminium safety bars
- Optional external screen (fixed or hinged)
- Optional panel frame

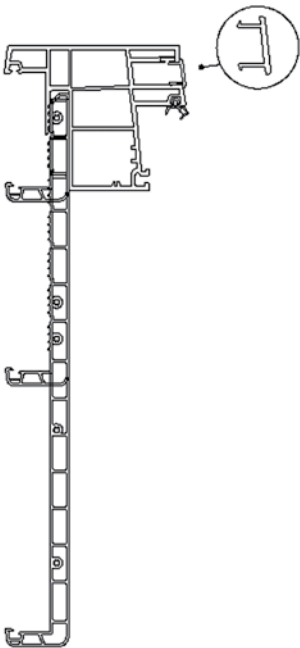

• Frame art. PR101 with slot for inserting an internal PVC frame.

Tightness Classes

Certification released by the IFT Rosenheim laboratories

- Air permeability: class 3 (in accordance with EN 12207)
- Water permeability: class 7A (in accordance with EN 12208)
- Heat transmission (in accordance with EN ISO 12567-1)
- Sound insulation: in accordance with EN 14351/1 annex B
- Reaction to fire: DIN 4102 B1
- Tested according to American and Canadian criteria

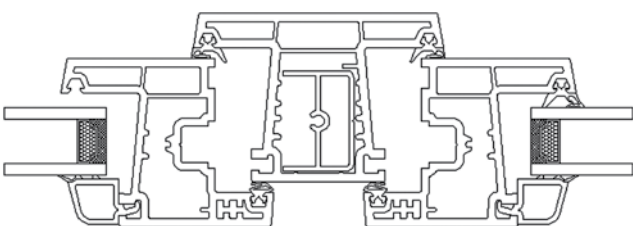

• Double tilt&turn window with central upright.

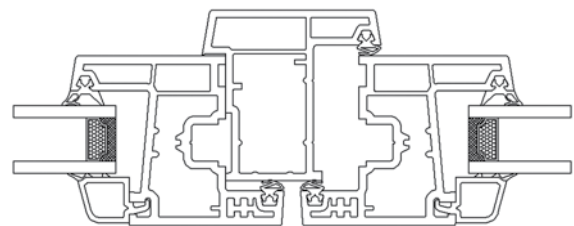

• 2-shutter window with 2 hinged shutter / 1 hinged and 1 tilt&turn shutter without central upright.

PIVA58

tilt&turn windows
with roller shutter
external fitting

The PIVA58 PVC tilt&turn window was designed for applications on outside and inside walls (mainly thin ones) of new, old, provisional or temporary structures.

This type of window is strong and practical, and the particular way it opens makes it suitable for every field of application.

The profiles are designed especially for systems with roller shutter or hinged PVC shutters.

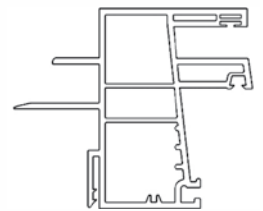
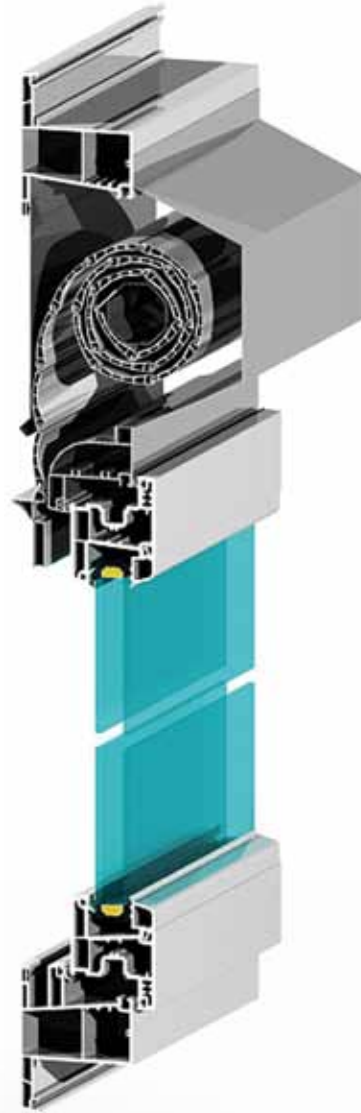

• Panel frame.

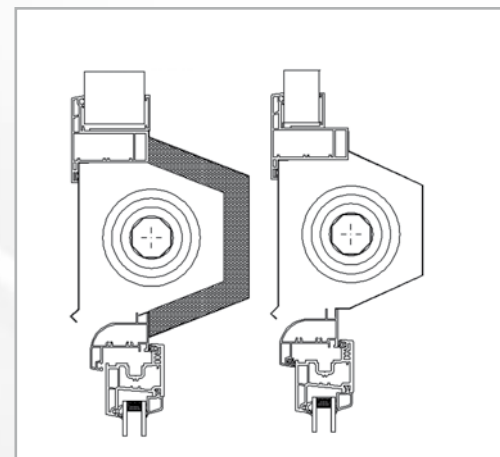

• Tilt&turn window with roller shutter
"frame with or without 24 mm
polystyrene insulation".

casement windows

Tilt&turn window - PIVA58

with roller shutter - **external** fitting

Technical Information

- Extruded profiles in white rigid PVC
- Seal system with co-extruded EPDM joints on the panel and frame
- Depth of frame system: 77 mm
- Depth of panel: 58 mm
- Choice of glass between 23 and 30 mm thick (single or double glazing)
- Opening system with modular fittings made of galvanized steel and with pressure die cast aluminium components
- Closing system with white nylon handle
- Optional surface coating applied by top certified specialized firms
- Optional application of aluminium safety bars
- Optional external insect screen (fixed or hinged)
- Optional panel frame

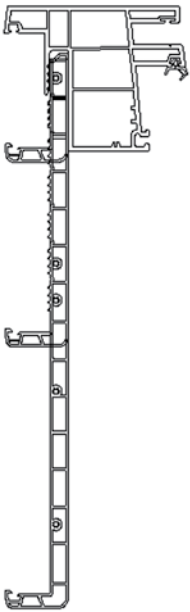

- Frame art. PR 101 with slot for inserting an internal PVC frame with roller shutter.

Tightness Classes

Certification released by the IFT Rosenheim laboratories

- Air permeability: class 4 (in accordance with EN 12207 Annex 1 – EN 14351-1:2010)
- Water permeability: class 7A (in accordance with EN 12208)
- Heat transmission (in accordance with EN ISO 12567-1/2 with glass $U_g=1.1 \text{ W/m}^2\text{K}$) [roller shutter wound: $1.6 \text{ W/m}^2\text{k}$ - roller shutter unwound: $1.3 \text{ W/m}^2\text{k}$]
- Sound insulation: in accordance with EN 14351/1 annex B
- Reaction to fire: DIN 4102 B1
- Tested according to American and Canadian criteria

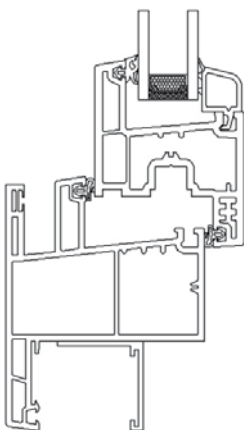

- Single-leaf tilt&turn window with roller shutter.

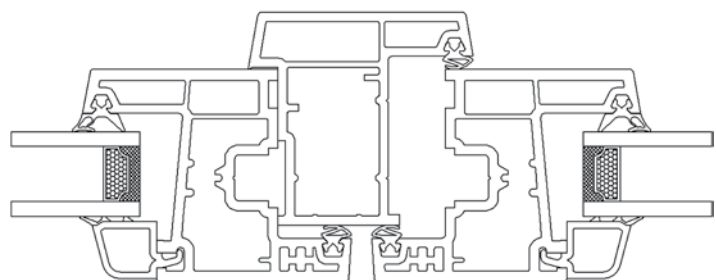

- Double-leaf tilt&turn window without central upright and with roller shutter.

PIVA58

tilt&turn windows
internal fitting

The PIVA58 PVC tilt&turn window was designed for applications on outside and inside walls (mainly thin ones) of new, old, provisional or temporary structures.

This type of window is strong and practical, and the particular way it opens makes it suitable for every field of application.

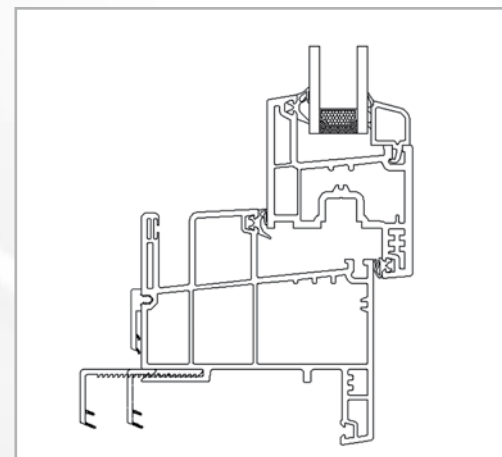

• Single-leaf tilt&turn window without roller shutter.

Technical Information

- Extruded profiles in white rigid PVC
- Seal system with co-extruded EPDM joints on the panel and frame
- Depth of frame system: 92 mm
- Depth of panel: 58 mm
- Choice of glass between 23 and 30 mm thick (single or double glazing)
- Opening system with modular fittings made of galvanized steel and with pressure die cast aluminium components
- Closing system with white nylon handle
- Optional surface coating applied by top certified specialized firms
- Optional application of aluminium safety bars
- Optional external insect screen (fixed or hinged)

Tightness Classes

Certification released by the IFT Rosenheim laboratories

- Air permeability: class 3 (in accordance with EN 12207)
- Water permeability: class 7A (in accordance with EN 12208)
- Heat transmission in accordance with EN ISO 12567-1)
- Sound insulation: in accordance with EN 14351/1 annex B
- Reaction to fire: DIN 4102 B1
- Tested according to American and Canadian criteria

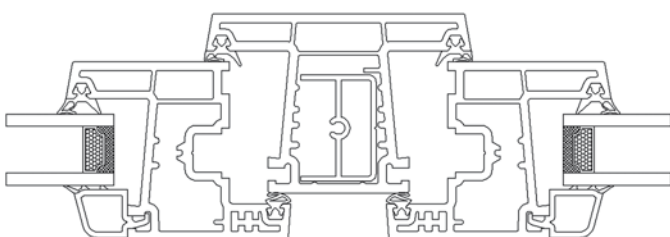

• Double-leaf tilt&turn window with central upright.

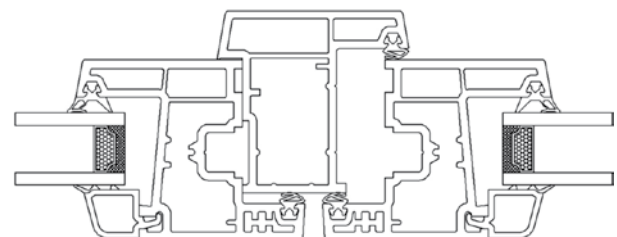

• Double-leaf tilt&turn window without central upright and without roller shutter.

PIVA58

tilt&turn windows
with roller shutter
internal fitting

The PIVA58 PVC tilt&turn window was designed for applications on outside and inside walls (mainly thin ones) of new, old, provisional or temporary structures.

This type of window is strong and practical, and the particular way it opens makes it suitable for every field of application.

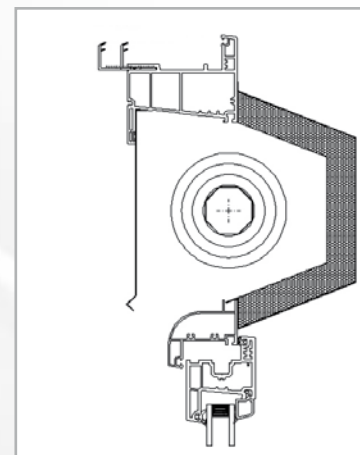

• Double-leaf tilt&turn window
with central upright and roller shutter.

casement windows

Tilt&turn window - PIVA58

with roller shutter - **internal** fitting

Technical Information

- Extruded profiles in white rigid PVC
- Seal system with co-extruded EPDM joints on the panel and frame
- Depth of frame system: 92 mm
- Depth of panel: 58 mm
- Choice of glass between 23 and 30 mm thick (single or double glazing)
 - Opening system with modular fittings made of galvanized steel
 - and with pressure die cast aluminium components
- Closing system with white nylon handle
- Optional surface coating applied by top certified specialized firms
- Optional application of aluminium safety bars<0}
- Optional external insect screen (fixed or hinged)<0}

Tightness Classes

Certification released by the IFT Rosenheim laboratories

- Air permeability: class 4 (in accordance with EN 12207)
- Water permeability: class 7A (in accordance with EN 12208)
- Heat transmission (in accordance with EN ISO 12567-1/2 with glass $U_g=1.1 \text{ W/m}^2\text{K}$)
[Roller shutter wound: $1.6 \text{ W/m}^2\text{k}$ - Roller shutter unwound: $1.3 \text{ W/m}^2\text{k}$]
- Sound insulation: in accordance with EN 14351/1 annex B
- Reaction to fire: DIN 4102 B1
- Tested according to American and Canadian criteria

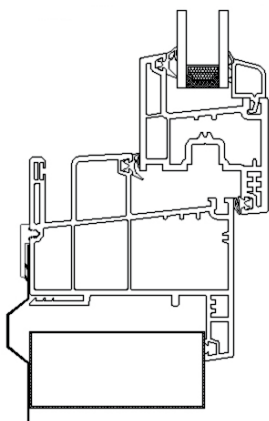

• PVC profile for lateral outer edge of panel.

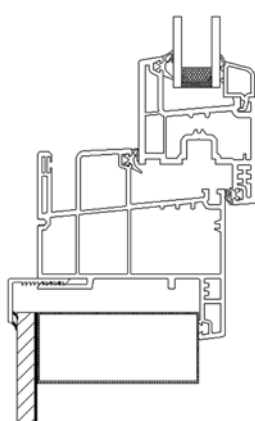

• PVC profile for bottom outer edge of panel.

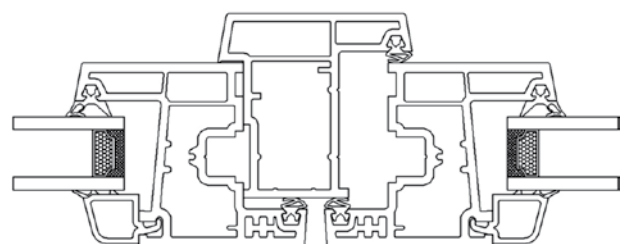

• Double-leaf tilt&turn window without central upright and with roller shutter.

PIVA75

tilt&turn windows
external fitting

The "PIVA 75" PVC tilt&turn window was designed for applications on outside and inside walls (mainly thin ones) of new, old, provisional or temporary structures.

This type of window is strong and practical, and the particular way it opens makes it suitable for every field of application.

The frame and panel profiles have a structure comprising 7 chambers with steel reinforcements, ensuring excellent heat insulation. The rounded profiles also make for a pleasing design.

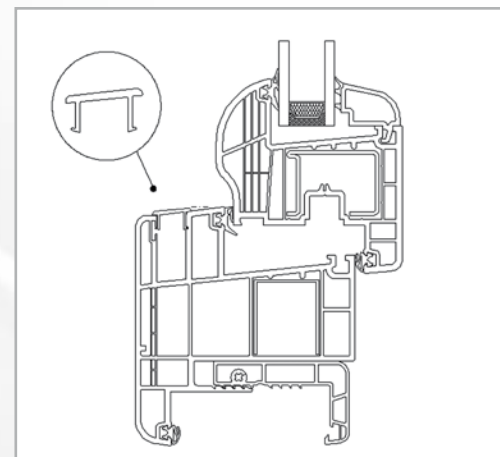

- Possibility for external shutters.

- Single-leaf tilt&turn window without roller shutter.



Technical Information

- Extruded profiles in white rigid PVC
- Seal system with co-extruded EPDM joints on the panel and frame
- Depth of frame system: 91 mm
- Depth of panel: 77 mm
- Choice of glass between 23 and 39 mm thick (single or double glazing)
- Opening system with modular fittings made of galvanized steel and with pressure die cast aluminium components
- Closing system with white alloy handle
- Optional surface coating applied by top certified specialized firms
- Optional application of aluminium safety bars<0}

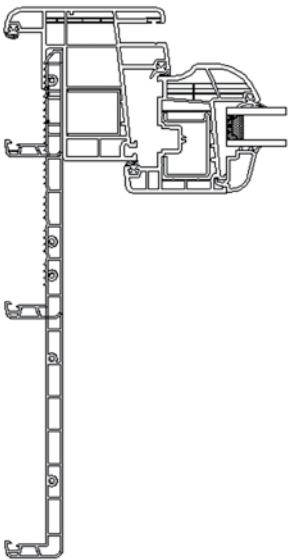

• Single-leaf tilt&turn window without roller shutter.

Tightness Classes

Certification released by the IFT Rosenheim laboratories

- Air permeability: class 4 (in accordance with EN 12207)
- Water permeability: class 8A (in accordance with EN 12208)
- Wind resistance: class C5/B5 (in accordance with EN 12210)
- Heat transmission (in accordance with EN ISO 12567-1/2 with glass $U_g=1.1 \text{ W/m}^2\text{K}$) $1.5 \text{ W/m}^2\text{k}$
- Sound insulation: in accordance with EN 14351/1 annex B
- Reaction to fire: DIN 4102 B1

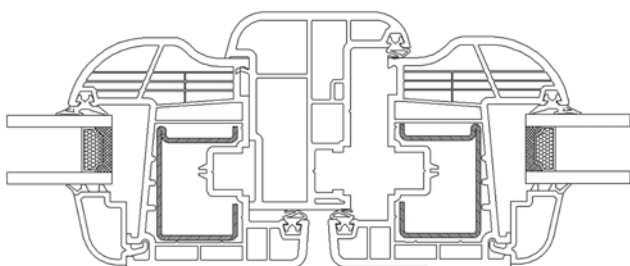

• Double-leaf tilt&turn window without central upright and without roller shutter.

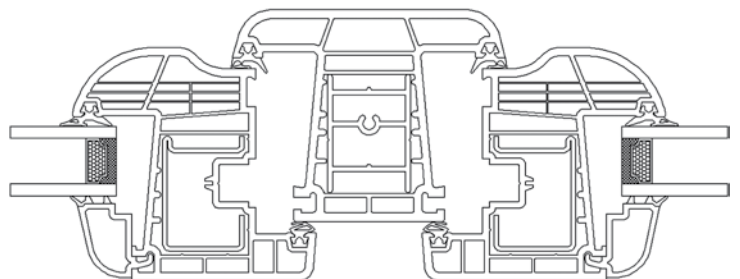

• Double-leaf tilt&turn window with central upright.

PIVA75

tilt&turn windows
with roller shutter
external fitting

The "PIVA 75" PVC tilt&turn window was designed for applications on outside and inside walls (mainly thin ones) of new, old, provisional or temporary structures.

This type of window is strong and practical, and the particular way it opens makes it suitable for every field of application. The frame and panel profiles have a structure comprising 7 chambers with steel reinforcements, ensuring excellent heat insulation. The rounded profiles also make for a pleasing design.

The profiles are designed especially for systems with roller shutters or hinged PVC shutters.

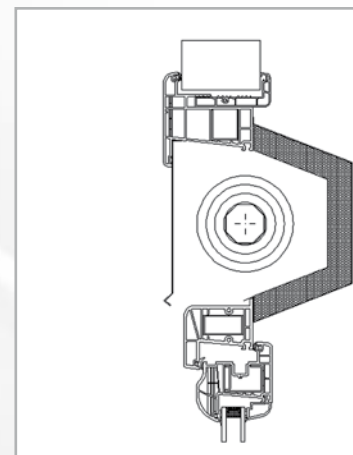
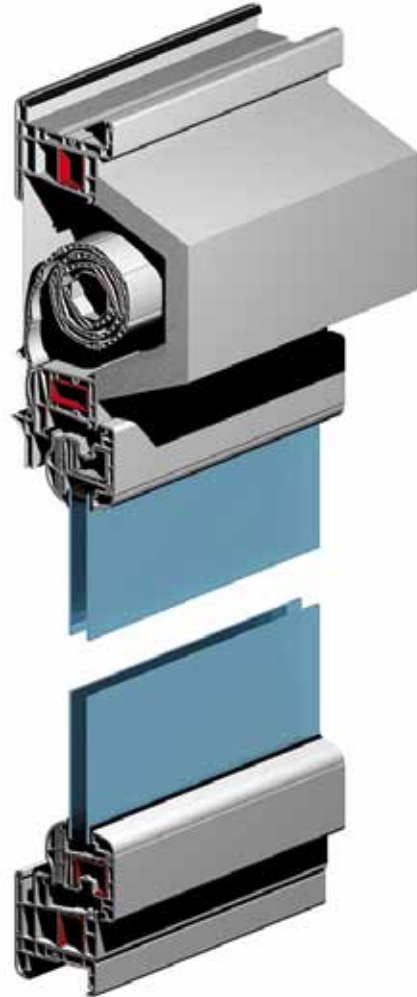

• Double-leaf tilt&turn window with central upright and roller shutter.

casement windows

Tilt&turn window - PIVA75

with roller shutter - **external** fitting

Technical Information

- Extruded profiles in white rigid PVC
- Seal system with co-extruded EPDM joints on the panel and frame
- Depth of frame system: 91 mm
- Depth of panel: 77 mm
- Choice of glass between 23 and 39 mm thick (single or double glazing)
- Opening system with modular fittings made of galvanized steel and with pressure die cast aluminium components
- Closing system with white alloy handle
- Optional surface coating applied by top certified specialized firms
- Optional application of aluminium safety bars

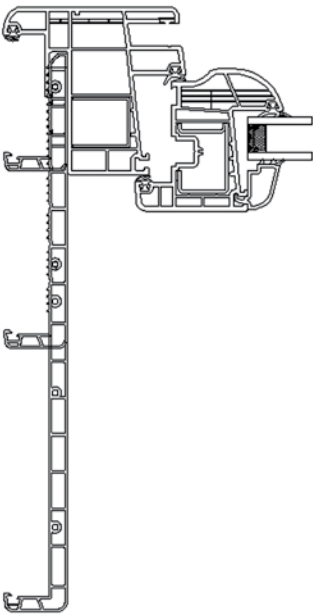

• *Single-leaf tilt&turn window with roller shutter.*

Tightness Classes

Certification released by the IFT Rosenheim laboratories

- Air permeability: class 4 (in accordance with EN 12207)
- Water permeability: class 8A (in accordance with EN 12208)
- Wind resistance: class C3/B3 (in accordance with EN 12210)
- Heat transmission (in accordance with EN ISO 12567-1/2 with glass $U_g=1.1 \text{ W/m}^2\text{K}$)
[Roller shutter wound: $1.4 \text{ W/m}^2\text{k}$ - Roller shutter unwound: $1.1 \text{ W/m}^2\text{k}$]
- Sound insulation: in accordance with EN 14351/1 annex B
- Reaction to fire: DIN 4102 B1

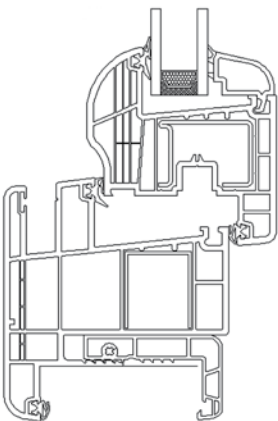

• *Single-leaf tilt&turn window with roller shutter.*

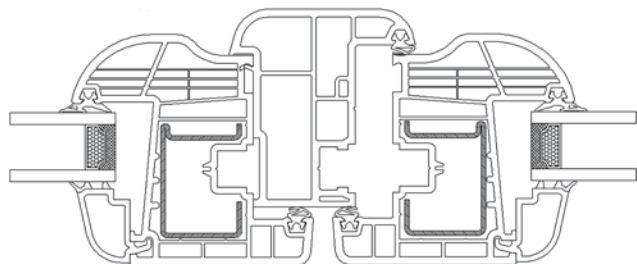

• *Double-leaf tilt&turn window without central upright and with roller shutter.*

PIVA75

tilt&turn windows
internal fitting

The "PIVA 75" PVC tilt&turn window was designed for applications on outside and inside walls (mainly thin ones) of new, old, provisional or temporary structures.

This type of window is strong and practical, and the particular way it opens makes it suitable for every field of application. The frame and panel profiles have a structure comprising 7 chambers with steel reinforcements, ensuring excellent heat insulation. The rounded profiles also make for a pleasing design.



Technical Information

- Extruded profiles in white rigid PVC
- Seal system with co-extruded EPDM joints on the panel and frame
- Depth of frame system: 91 mm
- Depth of panel: 77 mm
- Choice of glass between 23 and 39 mm thick (single or double glazing)
- Opening system with modular fittings made of galvanized steel and with pressure die cast aluminium components
- Closing system with white alloy handle
- Optional surface coating applied by top certified specialized firms
- Optional application of aluminium safety bars

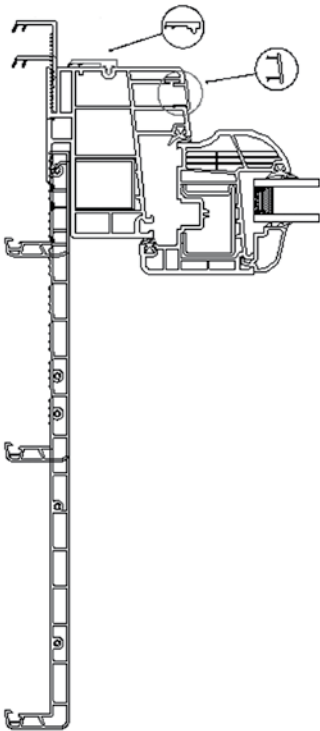

• Inward-opening frame with PVC profile and without roller shutter.

Tightness Classes

Certification released by the IFT Rosenheim laboratories

- Air permeability: class 4 (in accordance with EN 12207)
- Water permeability: class 8A (in accordance with EN 12208)
- Wind resistance: class C5/B5 (in accordance with EN 12210)
- Heat transmission (in accordance with EN ISO 12567-1/2 with glass $U_g=1.1 \text{ W/m}^2\text{K}$) $1.5 \text{ W/m}^2\text{k}$
- Sound insulation: in accordance with EN 14351/1 annex B
- Reaction to fire: DIN 4102 B1

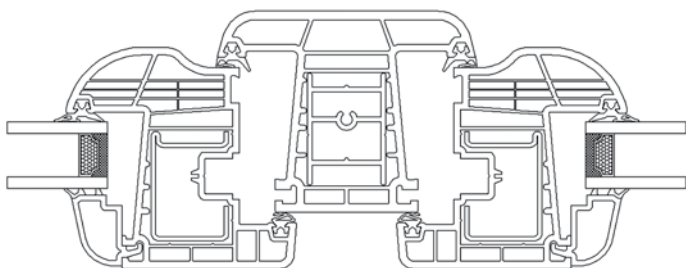

• Double-leaf tilt&turn window with central upright.

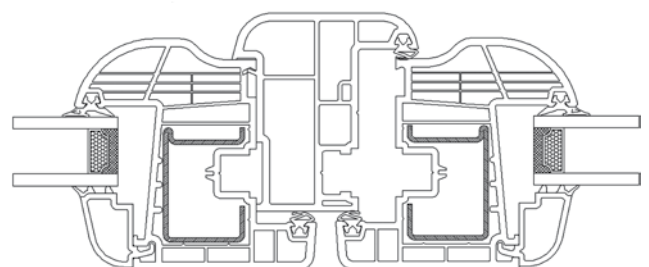

• Double-leaf tilt&turn window without central upright and without roller shutter.

PIVA75

tilt&turn windows
with roller shutter
internal fitting

The "PIVA 75" PVC tilt&turn window was designed for applications on outside and inside walls (mainly thin ones) of new, old, provisional or temporary structures.

This type of window is strong and practical, and the particular way it opens makes it suitable for every field of application. The frame and panel profiles have a structure comprising 7 chambers with steel reinforcements, ensuring excellent heat insulation. The rounded profiles also make for a pleasing design.

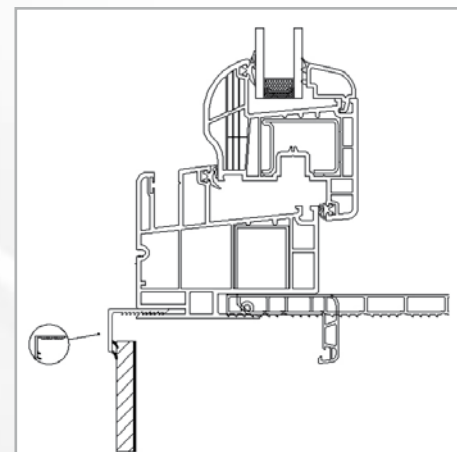
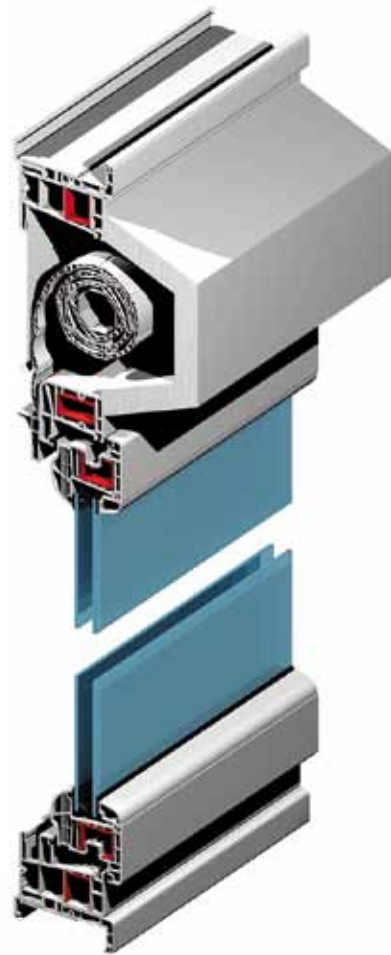

• PVC profile for bottom outer edge of panel.

casement windows

Tilt&turn window - PIVA75

with roller shutter - **internal** fitting

Technical Information

- Extruded profiles in white rigid PVC
- Seal system with co-extruded EPDM joints on the panel and frame
- Depth of frame system: 91 mm
- Depth of panel: 77 mm
- Choice of glass between 23 and 39 mm thick (single or double glazing)
- Opening system with modular fittings made of galvanized steel and with pressure die cast aluminium components
- Closing system with white alloy handle
- Optional surface coating applied by top certified specialized firms
- Optional application of aluminium safety bars

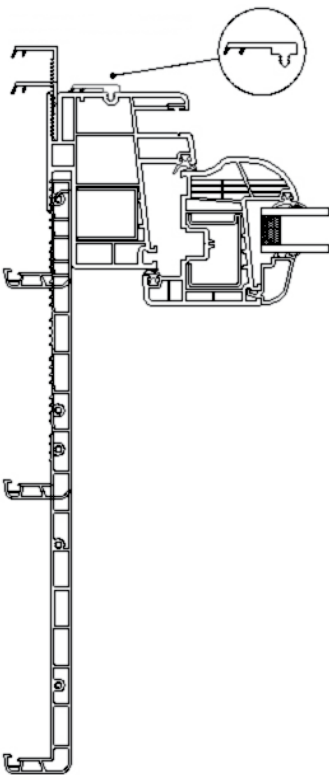

- Inward-opening frame with PVC profile and with roller shutter.

Tightness Classes

Certification released by the IFT Rosenheim laboratories

- Air permeability: class 4 (in accordance with EN 12207)
- Water permeability: class 8A (in accordance with EN 12208)
- Wind resistance: class C3/B3 (in accordance with EN 12210)
- Heat transmission (in accordance with EN ISO 12567-1/2 with glass $U_g=1.1 \text{ W/m}^2\text{K}$) [Shutter wound: $1.4 \text{ W/m}^2\text{k}$ - Shutter unwound: $1.1 \text{ W/m}^2\text{k}$]
- Sound insulation: in accordance with EN 14351/1 annex B
- Reaction to fire: DIN 4102 B1

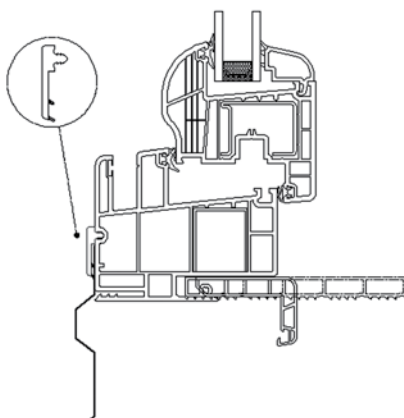

- PVC profile for lateral outer edge of panel.

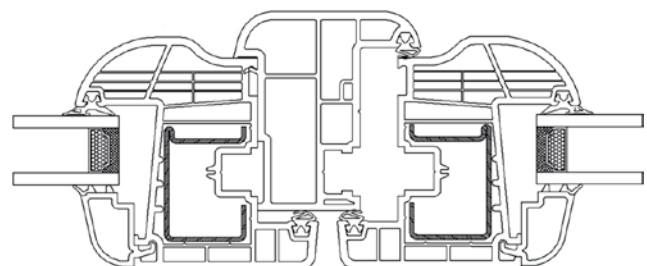

- Double-leaf tilt&turn window without central upright and with roller shutter.

PIVA58

projected windows

The PVC awning window was designed for applications on outside and inside walls (mainly thin ones) of new, old, provisional or temporary structures.

This type of window is strong and practical, and the particular way it opens makes it suitable for every field of application.

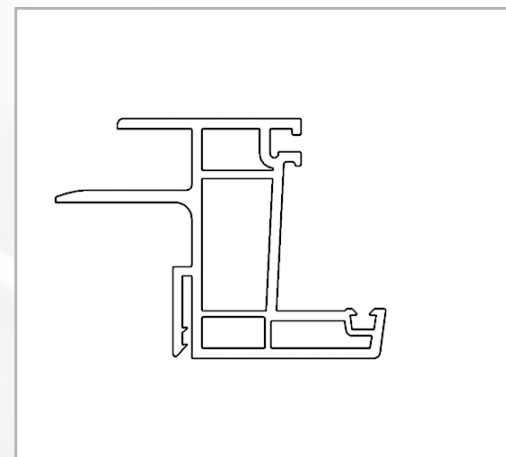

• Panel frame.

Technical Information

- Extruded profiles in white rigid PVC
- Seal system with co-extruded EPDM joints on the panel and frame
- Depth of frame system: 58 mm
- Depth of panel: 58 mm
- Choice of glass between 23 and 30 mm thick (single or double glazing)
- Panel frame
- Opening system with modular fittings made of galvanized steel and with pressure die cast aluminium components
- Closing system with white aluminium handle
- Optional surface coating applied by top certified specialized firms
- Optional application of aluminium safety bars
- Optional external insect screen (fixed, sliding or hinged)
- Optional panel frame

Tightness Classes

Certification released by Veneta Engineering, IT laboratories

- Air permeability: class 2 (in accordance with EN 12207)
- Water permeability: class 8A (in accordance with EN 12208)
- Wind resistance: class C4 (in accordance with EN 12210)
- Heat transmission in accordance with EN ISO 10077-1
- Sound insulation: in accordance with EN 14351/1 annex B
- Reaction to fire: DIN 4102 B1



• Projected window without roller shutter horizontal view.

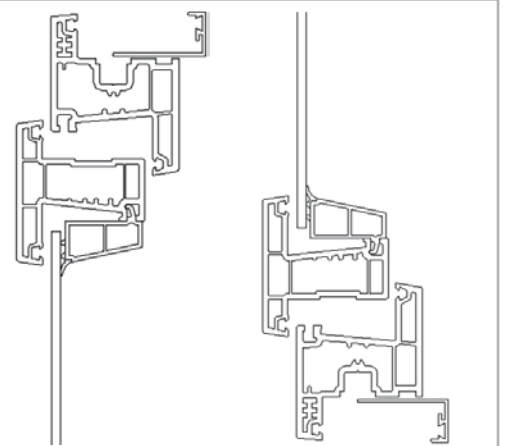

• Projected window without roller shutter - vertical view.

PIVA58

projected windows
with roller shutter

The PIVA58 PVC awning window was designed for applications on outside and inside walls (mainly thin ones) of new, old, provisional or temporary structures.

This type of window is strong and practical, and the particular way it opens makes it suitable for every field of application.

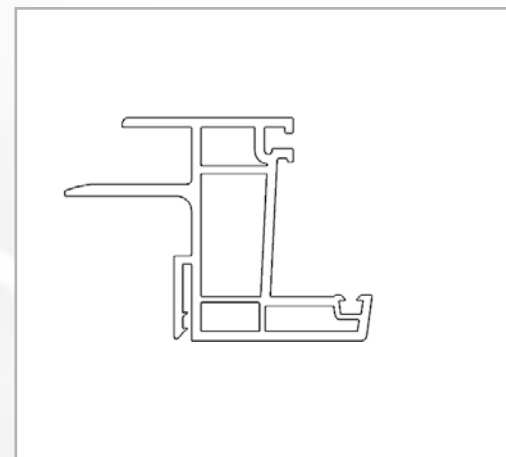

• Panel frame.

Technical Information

- Extruded profiles in white rigid PVC
- Seal system with co-extruded EPDM joints on the panel and frame
- Depth of frame system: 58 mm
- Depth of panel: 73 mm
- Choice of glass between 23 and 30 mm thick (single or double glazing)
- Opening system with modular fittings made of galvanized steel and with pressure die cast aluminium components
- Closing system with white nylon handle
- Optional surface coating applied by top certified specialized firms
- Optional application of aluminium safety bars
- Optional external insect screen (fixed or hinged)



Tightness Classes

Certification released by Veneta Engineering, IT laboratories

- Air permeability: class 1 (in accordance with EN 12207)
- Water permeability: class 8A (in accordance with EN 12208)
- Wind resistance: class C4 (in accordance with EN 12210)
- Heat transmission in accordance with EN ISO 10077-1
- Sound insulation: in accordance with EN 14351/1 annex B
- Reaction to fire: DIN 4102 B1

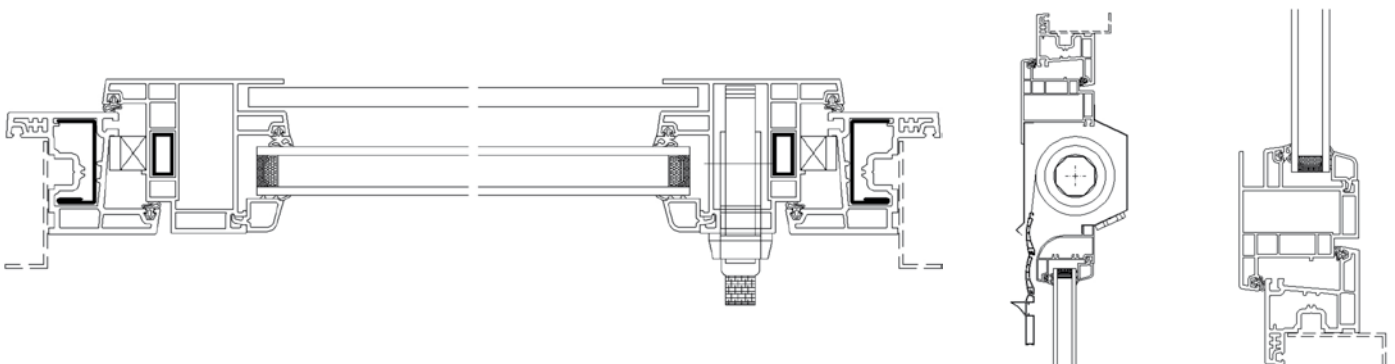

• Projected window with roller shutter - horizontal view.

• Projected window with roller shutter vertical view.

PIVA SLIDING

sliding windows

The PVC sliding window was designed for applications on outside and inside walls (mainly thin ones) of new, old, provisional or temporary structures.

This type of window combines strength and practicality: the panels slide along the same plane, convenient when space is restricted inside and outside, and there are steel reinforcements on the inside of each panel to ensure excellent wind resistance.



Technical Information

- Extruded profiles in white rigid PVC
- Set of brush seals
- Profiles designed mainly for outward opening windows
- Depth of frame system: 77 mm
- Depth of panel: 27 mm
- Option of glass 23 mm thick
- Steel reinforcement in the panel
- Sliding system with aluminium slides and plastic bearings
- Closing system with black nylon grab handles (or in-built aluminium closures)
- Optional surface coating applied by top certified specialized firms
- Optional fixed or sliding insect screen

Tightness Classes

Certification released by the Istituto Giordano laboratories, IT

- Air permeability: class 3 (in accordance with EN 12207)
- Water permeability: class 3A (in accordance with EN 12208)
- Wind resistance: class E2500 (in accordance with EN 12210)
- Heat transmission (EN ISO 10077-1): 2.00 W/m²*K
(with glass U_g=1.1 W/m²*K)
- Sound insulation: in accordance with EN 14351/1 annex B
- Reaction to fire: DIN 4102 B1
- Tested according to American and Canadian criteria

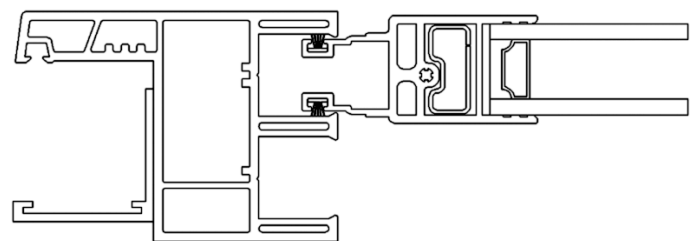
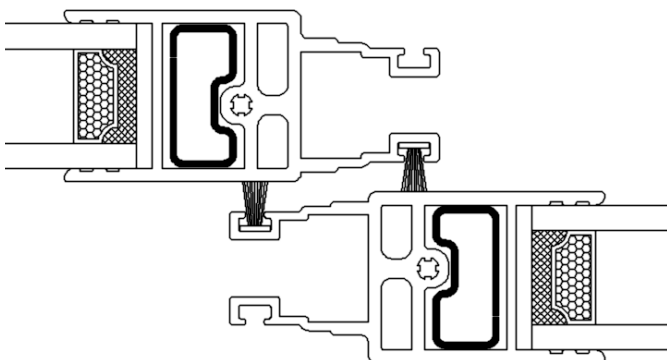

• Sliding window, central node, horizontal view.

• Sliding window, lateral node, horizontal view.

PIVA SLIDING

sliding windows
with roller shutter

The PVC sliding window was designed for applications on outside and inside walls (mainly thin ones) of new, old, provisional or temporary structures.

This type of window combines strength and practicality: the panels slide along the same plane, convenient when space is restricted inside and outside, and there are steel reinforcements on the inside of each panel to ensure excellent wind resistance.



Technical Information

- Extruded profiles in white rigid PVC
- Set of propylene brush seals on panels
- Profiles designed mainly for outward opening windows
- Depth of frame system: 77 mm
- Depth of panel: 27 mm
- Option of glass 23 mm thick
- Steel reinforcement s in the panel
- Sliding system with aluminium slides and plastic bearings
- Closing system with black nylon grab handles (or in-built aluminium closures)
- Optional surface coating applied by top certified specialized firms
- Optional fixed or sliding insect screen

Tightness Classes

Certification released by the Istituto Giordano laboratories, IT

- Air permeability: class 2 (in accordance with EN 12207)
- Water permeability: class 3A (in accordance with EN 12208)
- Wind resistance: class E2500 (in accordance with EN 12210)
- Heat transmission (EN ISO 10077-1): 2.20 W/m²*K (with glass U_g=1.1 W/m²*K)
- Sound insulation: in accordance with EN 14351/1 annex B
- Reaction to fire: DIN 4102 B1

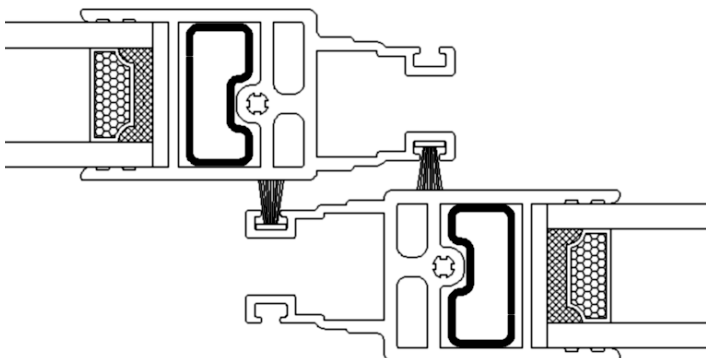

• Sliding window, central node, horizontal view.

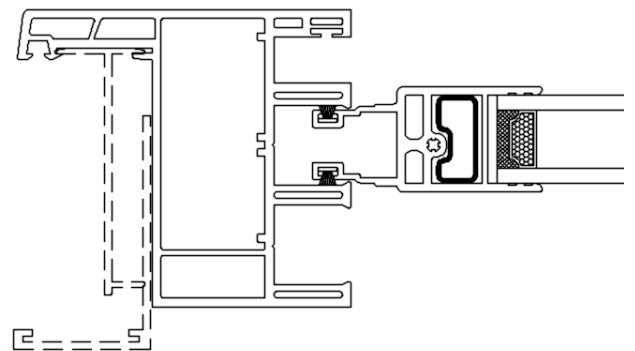

• Sliding window, lateral node, horizontal view.

PIVA SLIDING

Germany windows

The Germany PVC sliding window was designed for applications on outside and inside walls (mainly thin ones) of new, old, provisional or temporary structures.

This type of window combines strength and practicality: the panels slide along the same plane, convenient when space is restricted inside and outside.

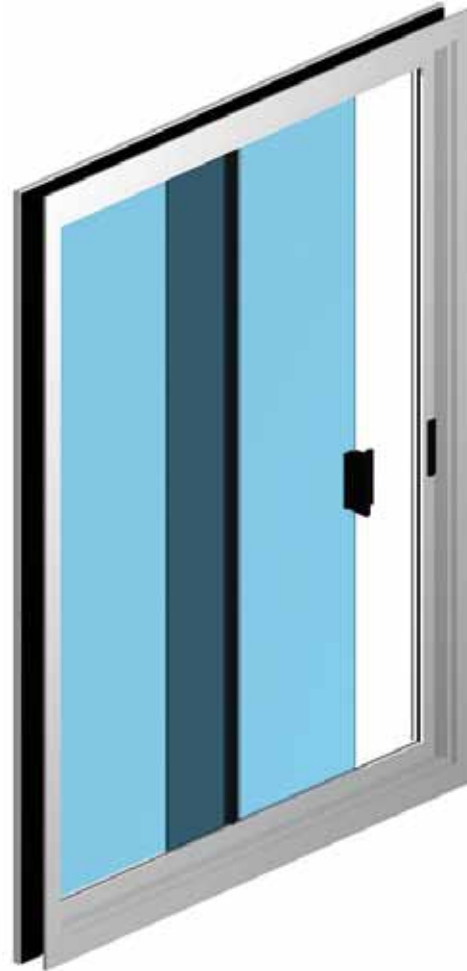

Technical Information

- Extruded profiles in white rigid PVC
- Set of propylene brush seals on panels
- Profiles designed mainly for outward opening windows
- Depth of U-shaped frame system: 40/50 mm Secondary frame 48 mm
- Depth of panel: 27 mm
- Sliding tempered glass panel 5 mm
- Fixed glass panel 4 mm
- Plastic sliding system
- Closing system with black nylon grab handles
- Optional fixed or sliding insect screen

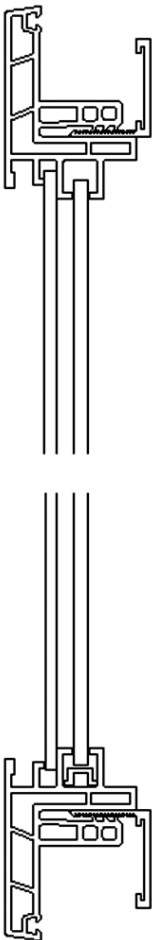

Tightness Classes

Certification released by Veneta Engineering laboratories, IT

- Air permeability: class 1 (in accordance with EN 12207)
- Water permeability: class 8A (in accordance with EN 12208)
- Wind resistance: class C4 (in accordance with EN 12210)
- Heat transmission in accordance with EN ISO 10077-1
- Sound insulation: in accordance with EN 14351/1 annex B
- Reaction to fire: DIN 4102 B1

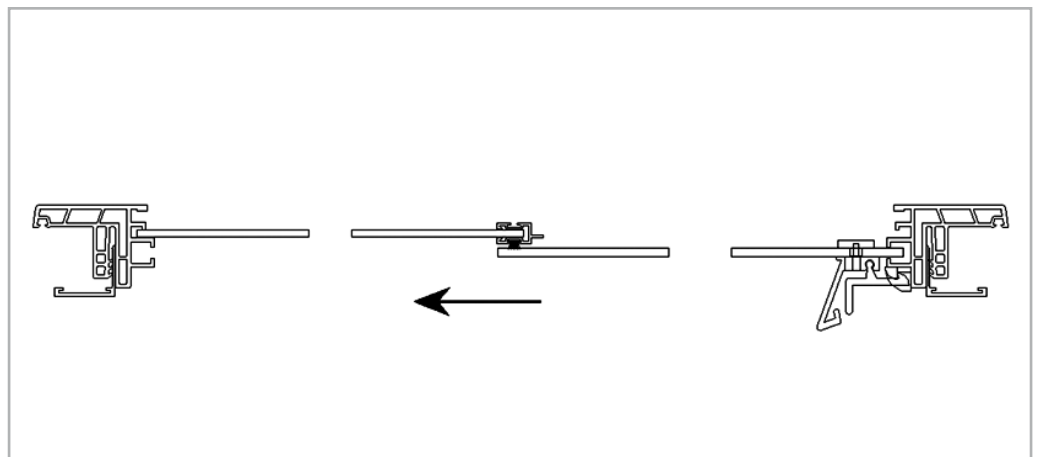

• Germany window, vertical view.

• Germany window, fixed glass panel on left, sliding glass panel on right, horizontal view.

PIVA SLIDING

Germany sliding windows

The Germany PVC sliding window was designed for applications on outside and inside walls (mainly thin ones) of new, old, provisional or temporary structures.

This type of window combines strength and practicality.

There are also steel reinforcements on the inside of each sliding panel to ensure excellent wind resistance.



Technical Information

- Extruded profiles in white rigid PVC
- Set of propylene brush seals on panels
- Profiles designed mainly for outward opening windows
- Depth of frame system: 58 mm
- Depth of panel: 27 mm
- 23 mm thick sliding glass panel
- 17 mm thick fixed glass panel
- Steel reinforcement in the panel
- Sliding system with aluminium slides and plastic bearings
- Closing system with black nylon grab handles (or in-built aluminium closures)
- Optional surface coating applied by top certified specialized firms
- Optional fixed or sliding insect screen

Tightness Classes

Certification released by Veneta Engineering laboratories, IT

- Air permeability: class 3 (in accordance with EN 12207)
- Water permeability: class 3A (in accordance with EN 12208)
- Wind resistance: class E2500 (in accordance with EN 12210)
- Heat transmission in accordance with EN ISO 10077-1/2
- Sound insulation: in accordance with EN 14351/1 annex B
- Reaction to fire: DIN 4102 B1
- Tested according to American and Canadian criteria

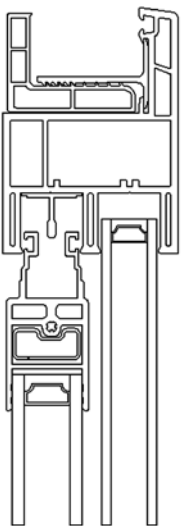

• Sliding Germany window, vertical view.

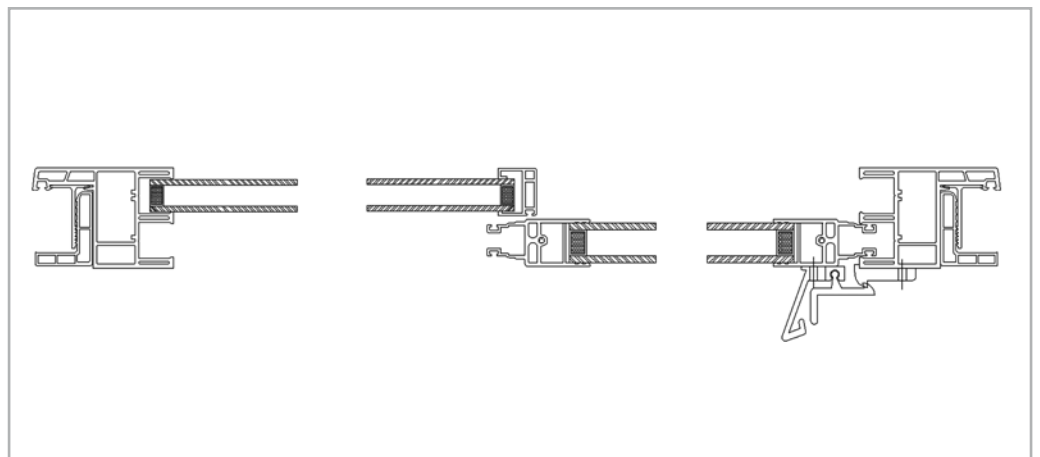

• Germany sliding window, fixed structural glass panel on left, sliding structural glass panel on right, horizontal view.

PIVA SLIDING

Germany
sliding windows
with roller shutter

The PVC sliding window was designed for applications on outside and inside walls (mainly thin ones) of new, old, provisional or temporary structures.

This type of window combines strength and practicality. There are also steel reinforcements on the inside of each sliding panel to ensure excellent wind resistance.

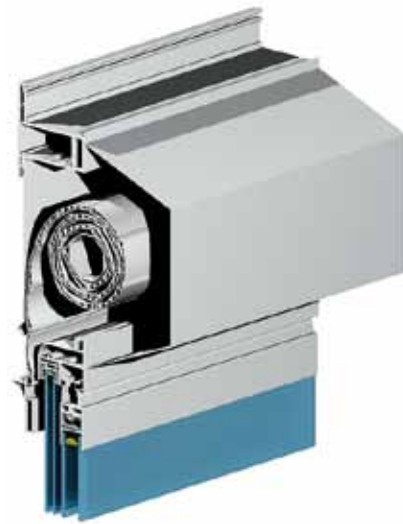

Technical Information

- Extruded profiles in white rigid PVC
- Set of propylene brush seals on panels
- Profiles designed mainly for outward opening windows
- Depth of frame system: 77 mm
- Depth of panel: 27 mm
- Option of glass 23 mm thick
- Steel reinforcement in the panel
- Sliding system with aluminium slides and plastic bearings
- Closing system with black nylon grab handles (or in-built aluminium closures)
- Optional surface coating applied by top certified specialized firms
- Optional fixed or sliding insect screen

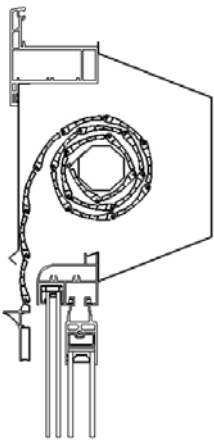

• Sliding Germany window with roller shutter, vertical view.

Tightness Classes

Certification released by Veneta Engineering laboratories, IT

- Air permeability: class 3 (in accordance with EN 12207)
- Water permeability: class 3A (in accordance with EN 12208)
- Wind resistance: class E2500 (in accordance with EN 12210)
- Heat transmission in accordance with EN ISO 10077-1/2
- Sound insulation: in accordance with EN 14351/1 annex B
- Reaction to fire: DIN 4102 B1

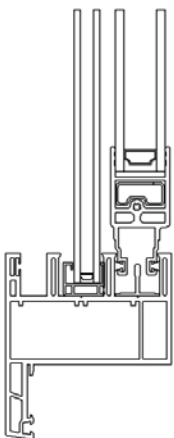

• Sliding Germany window vertical view.

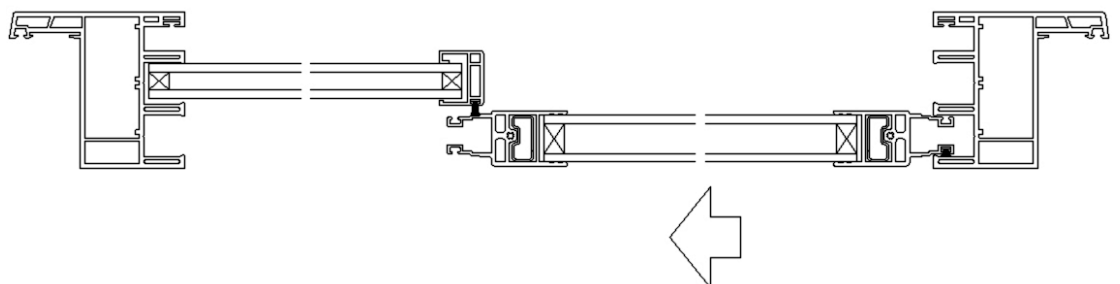

• Germany sliding window with roller shutter, fixed structural glass panel on left, sliding structural glass panel on right, horizontal view.

PIVA SALISCENDI

vertical sliding windows
with roller shutter

The PVC vertical sliding window was designed for applications on outside and inside walls (mainly thin ones) of new, old, provisional or temporary structures.

This type of window combines lightness and practicality. The panels slide along the same plane, convenient when space is restricted inside and outside; this type of window is used mainly for collection service facilities (ticket booths, etc.).

The vertical sliding window is certified by the National Fenestration Rating Council of America.

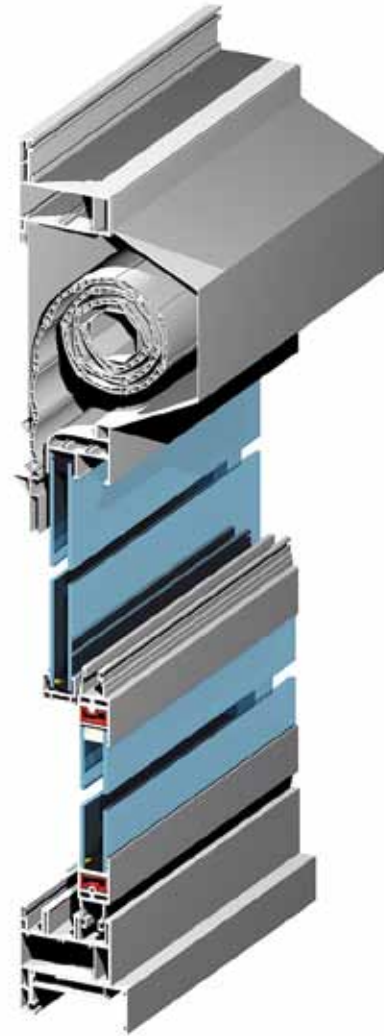

Technical Information

- Extruded profiles in white rigid PVC
- Seal system with co-extruded EPDM joints on the panel and frame
- Fin overlap: 6 mm; overlap at side of panel/frame: 5 mm;
- Depth of fixed frame: 77 mm;
- Depth of panel: 27 mm;
- 17 mm top fixed external compartment with structural glass;
- 23 mm bottom internal compartment that can be opened vertically with structural glass
- Optional fixed or sliding insect screen
- Closing system with white nylon handle
- Sliding opening system with friction mechanisms in the profile
- Optional surface coating applied by top certified specialized firms
- Optional external sliding insect screen and internal Venetian blind
- Optional clip fasteners

Tightness Classes

Certification released by Veneta Engineering laboratories, IT

- Air permeability: class 1 (in accordance with EN 12207)
- Water permeability: class 8A (in accordance with EN 12208)
- Wind resistance: class C4 (in accordance with EN 12210)
- Heat transmission (EN ISO 10077-1/2): 2.00 W/m²*K (with glass Ug=1.1 W/m²*K)
- Sound insulation: in accordance with EN 14351/1 annex B
- Reaction to fire: DIN 4102 B1
- Tested according to American and Canadian criteria

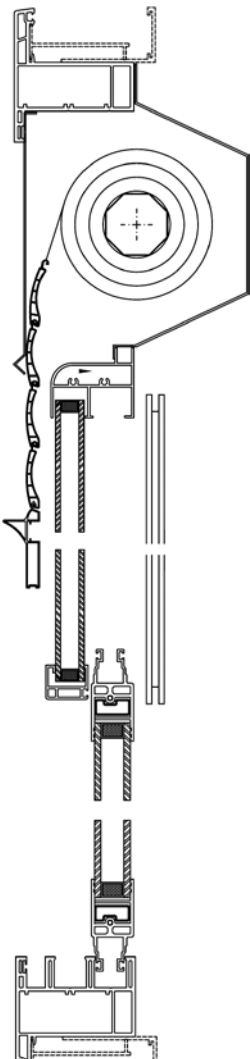

• Vertical sliding window with roller shutter, vertical view.

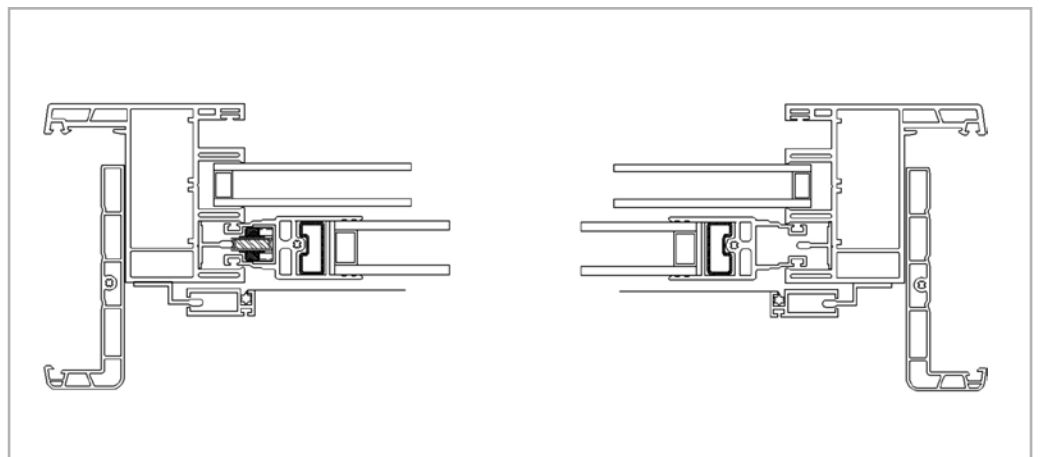

• Vertical sliding window with roller shutter, horizontal view.

Our products

Mondial Infissi offers a range of innovative products that make it one of the leaders in the construction of aluminium and PVC frames.

With Mondial Infissi, our company designs and creates frames to suit all requirements while always offering quality at a competitive price. Our company has a team of technicians who are happy to give advice and to install the products on site, when requested.

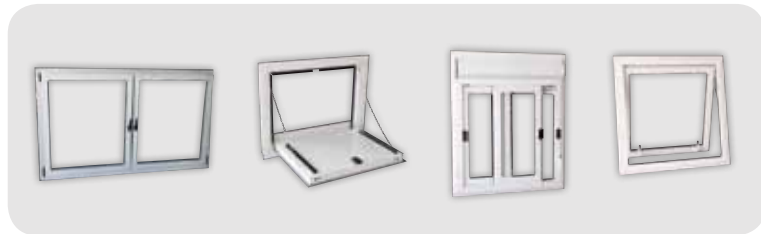

pre-fabricated building

The pre-fabricated goods department constructs aluminium and PVC frames for modular pre-fabricated units (modular housing units, insulated units, pre-fabricated boxes, etc.). The Germany, 2002, 2005 and NC50 series of heat transfer cut PVC frames are some of our products certified in accordance with strict European standards on air-water-wind classification and the "K" heat transfer coefficient. The company can satisfy all technically feasible needs thanks to the Group's technical-operating team, who devise the best solutions in collaboration with suppliers to certify and guarantee the durability of the final products and materials.



Pre-fabricated Building



mobil home



pre-fabricated building

There are many solutions for highlighting the aesthetic features of a building. The frames produced by the Piva Group are known for their high standard of quality and excellent durability.

In Europe, over the past few decades, PVC has been favoured above all other traditional materials for the construction of frames. This is mainly due to its technical quality and efficiency, a point of great attraction in many countries.

The benefits of the PVC frames made by Piva Group S.p.A. include:

- A high standard of sound insulation for greater comfort at home;
- Efficient heat insulation, saving on energy;
- Excellent weather resistance;
- Absolute wind resistance;
- No formation of condensation;
- Durability, with no need for maintenance.

Mobil Home and Pre-fabricated Building



Piva Group is also known for Pannelli System, a benchmark company in the production of insulated sandwich panels using the discontinuous construction process. It makes all kinds of sandwich panels, even complex ones, with different types of insulation from polyurethane resin to polystyrene foam with oriented fibres and optional inserts made of wood, iron, plastic or other materials.

Pannelli System can offer unlimited production with its discontinuous plants to meet the increasingly difficult and complex needs found in the world of design. To complete the product range and to keep the Piva Group up to date at all times, new generation plant has now been installed, which produces insulated panels with a “continuous construction process” with high performance and faster.

Thanks to the high capacity these plants provide, the Pannelli System division can meet any market need – a commercial advantage that puts us in a unique position.

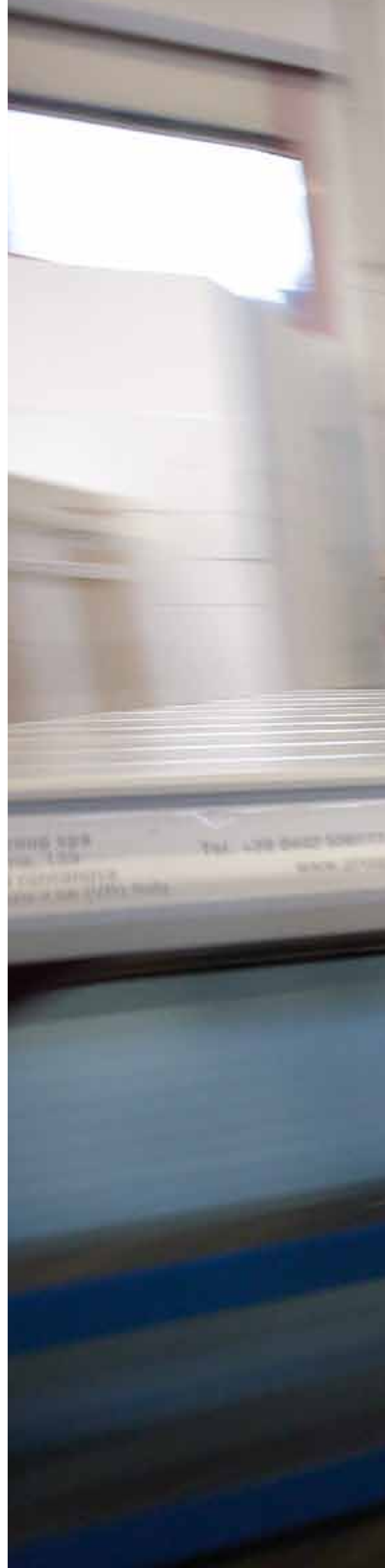
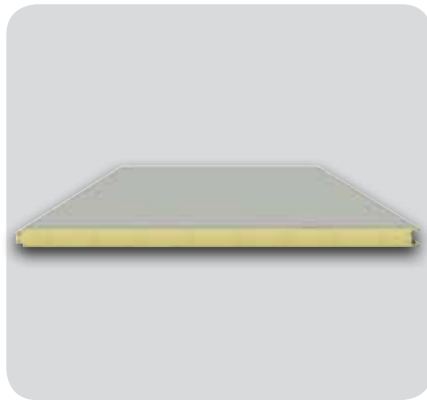
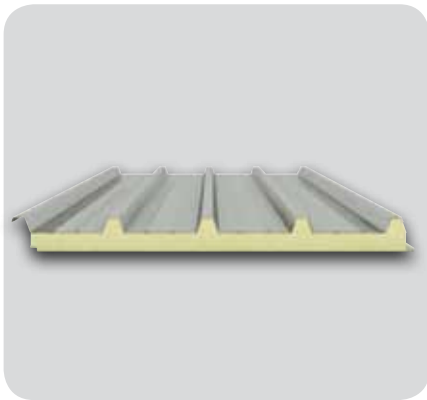

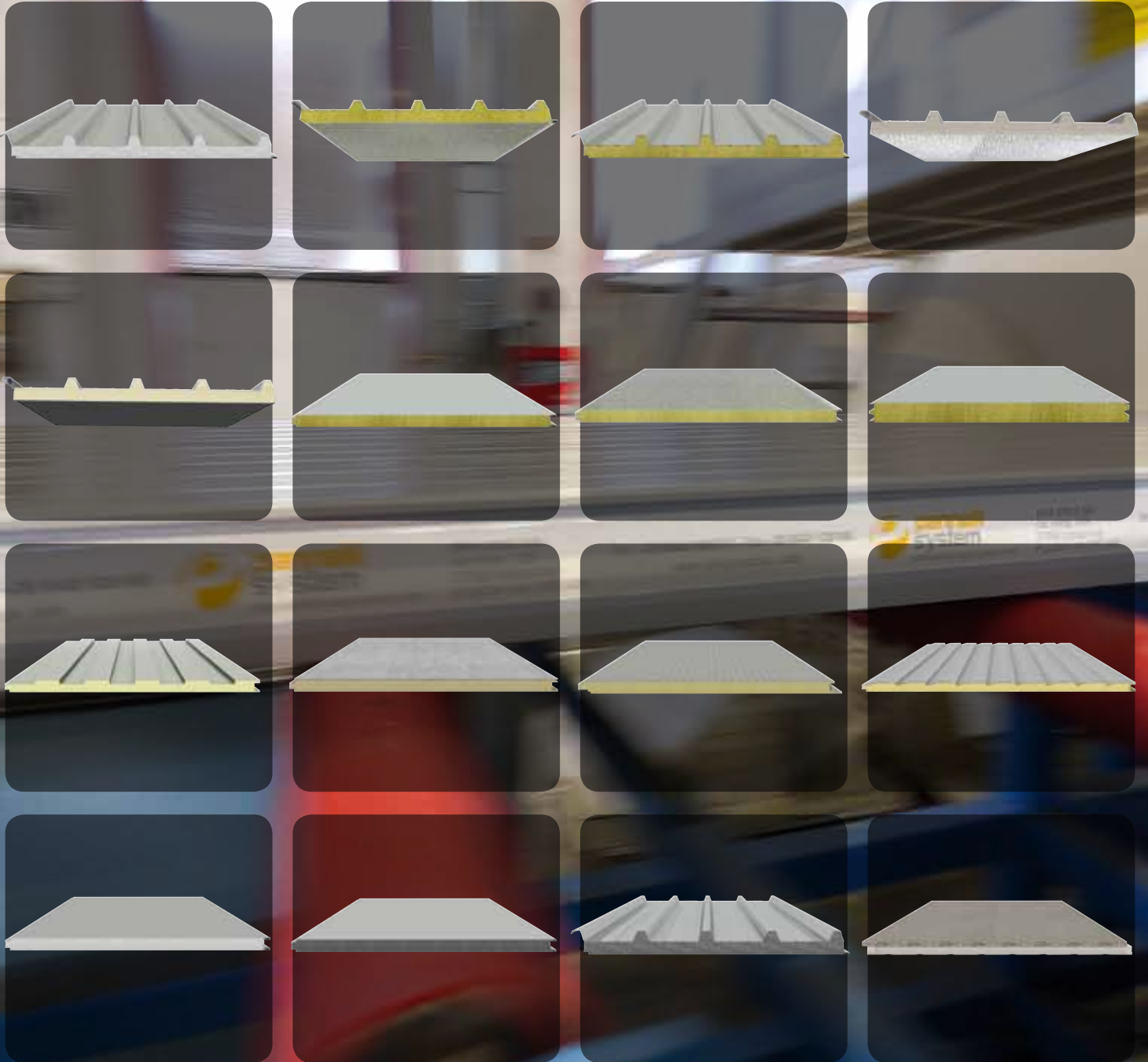



piva group spa
via roma, 139
37060 roncanova
di gazzo v.se (VR) italy
tel. +39 0442 536111
fax +39 0442 536180

